

# ⚡ | DRIVE

THE **BRADLEY**  
COLLECTION

SPECIFICATION GUIDE

## SPECIFICATION GUIDE

This specification guide was designed to outline the main considerations that need to be made when quoting or ordering a system.

Please use this along side with the ⚡ | Electric Technical Guide's. There is a guide for Silent Gliss • Somfy • Lutron system options which deal with specific details of those systems.

If any questions arise please call your local sales representative or contact The Bradley Collection directly.



**Electrical installations must be carried out by qualified professionals. In line with the relevant wiring diagrams and conform to local regulations.**

### System Information Page 3-26

POLES Page 4

DRIVE OPTIONS Page 5

JOINTING SYSTEM Page 6

BAYS & MINIMUM WALL SIZES Page 7

BRACKET ALIGNMENT Page 8

CUSTOM BRACKETS Page 9

CURTAIN DROPS Page 10-11

SYSTEM CONFIGURATION Page 12-13

POLE CONFIGURATION Page 14-17

CURTAIN STACKS Page 18

GLIDING OPTIONS & CURTAIN HEADINGS Page 19-20

CURTAIN WEIGHTS Page 21

MAXIMUM WEIGHTS Page 22-23

OVERLAP ARMS Page 24-26

### Finishes Page 27-30

### Finials Page 31-41

### Poles Page 42-54

### Brackets Page 55-62



Poles are cut, bent and curved to suit individual requirements. When calculating the length of your pole, remember to allow tolerance beyond the width of the frame for the curtains to draw back to the edge of the window.

Maximum pole length in one piece 4.0m (157")<sup>Ⓒ</sup>.  
 Poles exceeding the maximum length will be cut into equal parts unless otherwise specified.  
 Jointing system will be supplied. (See page 6) Brackets should be placed at every join.

Ø30mm (1 3/16") • 38mm (1 1/2")

The overall pole cost is rounded up in 300mm (1ft) increments.

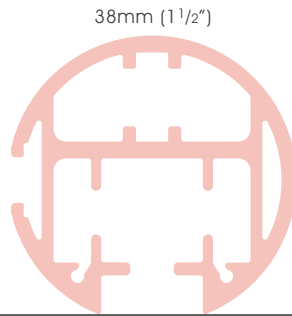

Diameter	Maximum distance between brackets	Minimum bend radius
Ø38mm (1 1/2")	1000mm (39")	Ⓜ400mm (16")

## PROVIDING POLE LENGTHS

Pole lengths can be specified in two ways.

**OPTION A** is our preferred method. This covers Pole length only. **OPTION B** combines pole and finial lengths.

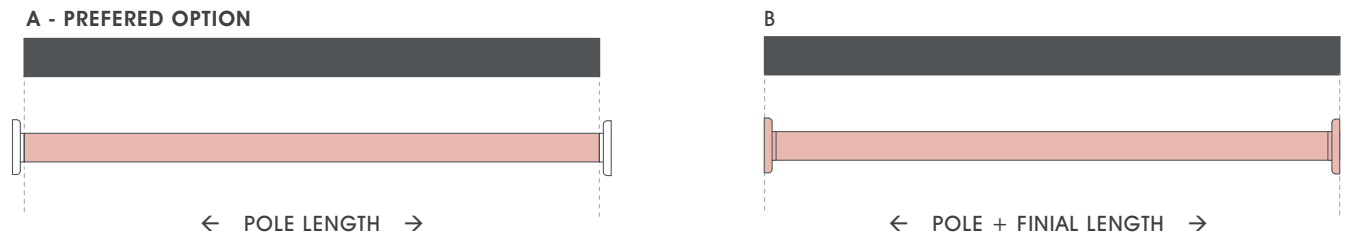



## SELECT TRACK TYPE & MOTOR

Specify you DRIVE from a choice from the leading motor brands. This provides power and control options ranging from standalone battery powered systems to fully integrated home automation solutions.



For double configurations a second DRIVE system can be specified.

It is also possible to specify a motor to the main curtain and a manual pole to the rear. Simply select DRIVE for the front pole and either GLIDE Ø30mm (1<sup>3</sup>/<sub>16</sub>"") or 38mm (1<sup>1</sup>/<sub>2</sub>"") for the rear.

### LUTRON



**1 MOTOR OPTIONS**

- ⚡ D105
- ⚡ D145
- ⚡ D175

Radio dongle required for use to wireless control options

**2 CONTROL OPTIONS**

**Remote Control**

Single hand held remote control option available.

**App Control - RA2 Select**

The system can be controlled with the Lutron app or through smart devices & Amazon Alexa.

**Automation Systems**

The system can also be intergrated with all major home control systems.<sup>(A)</sup>

### SOMFY



**1 MOTOR OPTIONS**

- ⚡ Glydea Ultra 60e WT
- ⚡ Glydea Ultra 60e RTS
- 🔋 Irismo 45 WF RTS
- ⚡ Movelite 35 WT
- ⚡ Movelite 35 RTS
- 🔋 Movelite 35 WF RTS<sup>(C)</sup>

RTS required for use to wireless control options

**2 CONTROL OPTIONS**

**Remote Control**

Single channel & Multi-channel hand held remote control options available.

**App Control - Tahoma**

The system can be controlled with th Somfy Tahoma app or through smart devices & Amazon Alexa.

**Automation Systems**

The system can also be intergrated with all major home control systems.<sup>(A)</sup>

### SILENT GLISS



**1 MOTOR OPTIONS**

- ⚡ 9060 Motor
- ⚡ 9060 Motor with radio module

Radio module required for use to wireless control options

**2 CONTROL OPTIONS**

**Remote Control**

Single & Multi-channel hand held remote control options available.

**App Control - Move**

The system can be controlled with the Silent Gliss Move<sup>(M)</sup> app to allow control on smart devices.

**Automation Systems**

The system can also be intergrated with all major home control systems, and via Silent Gliss Smart<sup>(S)</sup> system allowing two way integration with all major home control systems<sup>(A)</sup>

Drive's jointing system ensures perfect alignment between pole sections.

Joints must always be supported by a bracket.

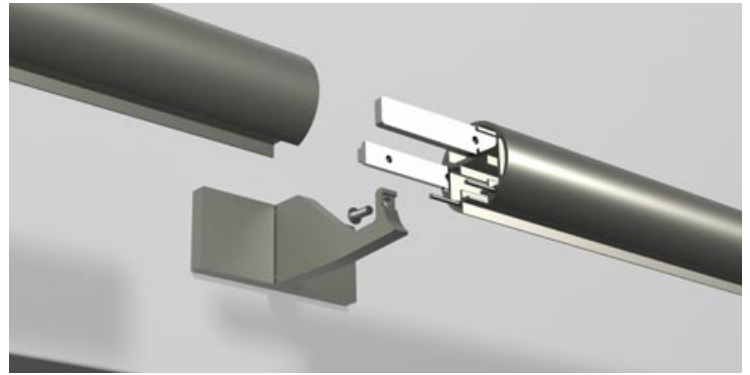

38mm (1 1/2")

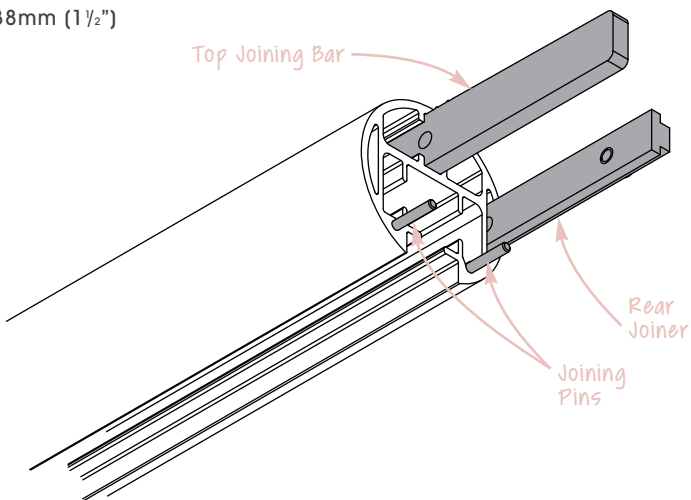

Bradley's bespoke service allows poles to be specifically made for unique bay windows and complex long span installations. Poles can be shaped to create a system that follows contours.

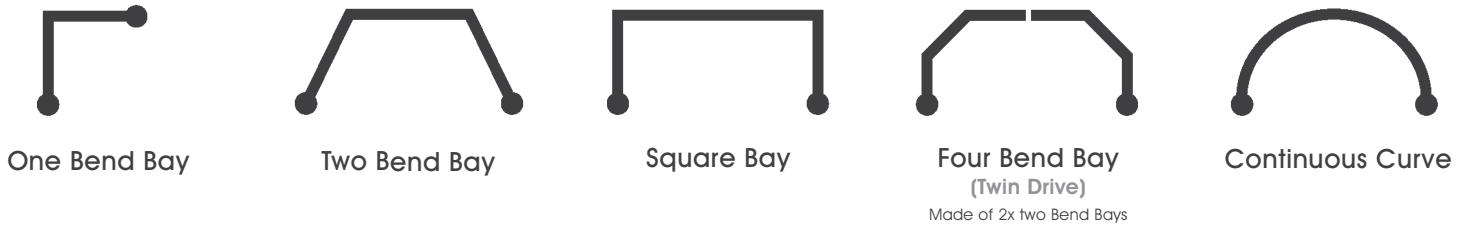

! Return bends are not available.

## MINIMUM WALL SIZES

135° Bend Angles

90° Bend Angles

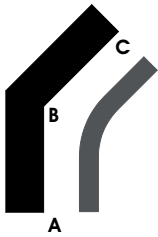

Diameter	Wall A - B	Wall B - C	Angle at B	Minimum Bend Radius	Minimum Projection
∅38mm (1½")	316mm (12 <sup>7</sup> / <sub>16</sub> "	316mm (12 <sup>7</sup> / <sub>16</sub> "	135°	400mm (16")	100mm (4")
∅38mm (1½")	550mm (21 <sup>5</sup> / <sub>8</sub> "	550mm (21 <sup>5</sup> / <sub>8</sub> "	90°	400mm (16")	100mm (4")

## BRADLEY BAY CHECKER +

Bay Checker + is part of our Digital Toolbox, allowing you to check your measurement for bays and curves whilst onsite, as well as storing straight window dimensions for your projects.

Unlimited measurements may be saved locally to your device or shared to your colleagues.

Available as a free download for iOS or Android,

For more information on Bay Checker + and latest enhancements to our Digital Toolbox visit

[www.bradleycollection.com/digital-toolbox/](http://www.bradleycollection.com/digital-toolbox/)

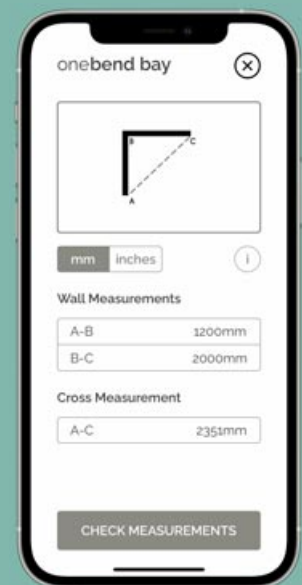

The information below shows the relationship between the bracket backplate. this will enable easy alignments during instalation.

**SINGLE SYSTEM -  $\varnothing 38\text{mm}$  (1 1/2")**

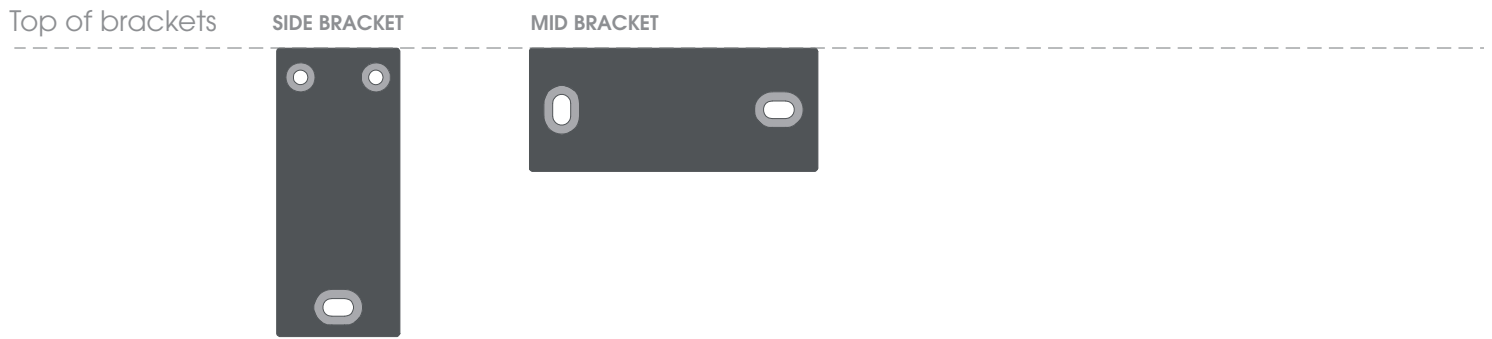

**DOUBLE SYSTEMS**

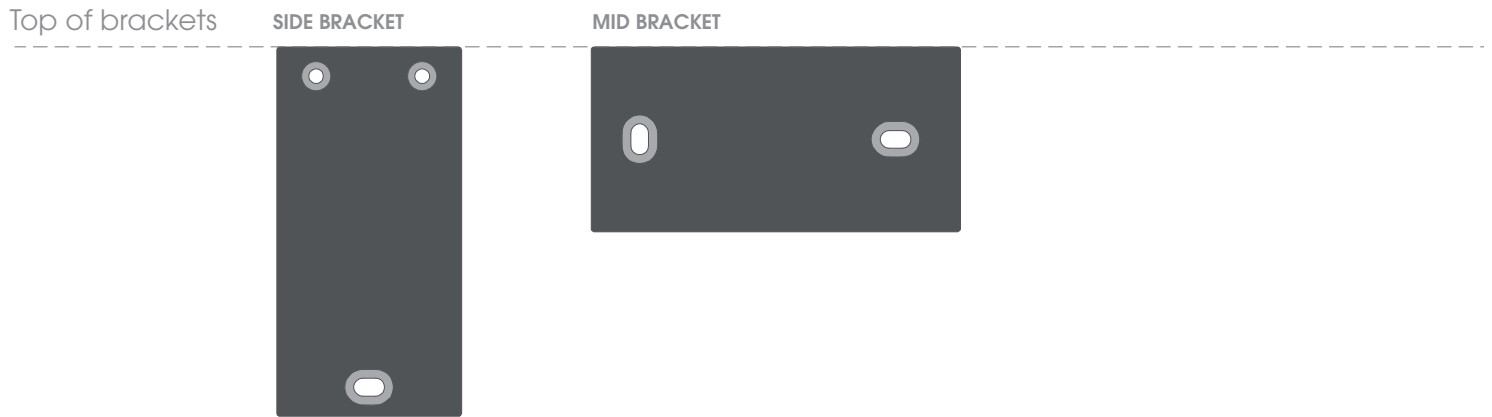

Drive can be customised to suit virtually any window. For simple projection changes between the Minimums and Maximums listed below brackets are charged at double their standard costs. For all other customisations an additional custom fee is applied per drawing



### Custom Projection

Specify the exact projection needed.



### Custom Fixing Plate

Relevant where space is restricted or weight is a concern.



### Uplift

Helps negotiate cornice and similar architectural features.



### Ceiling Brackets

Specify exact projection required from ceiling.



### Angled Brackets

The solution for tight and awkward locations.

## Minimum & Maximum Bracket Projections

Dimensions outside of these stated min/max projections may still be possible but will generate a design charge per drawing. See price list for details

Diameter	Type	Standard Projection(s)	Minimum Special Projection	Maximum Special Projection
∅38mm (1½")	Side	100mm (4")	95mm (3¾")	200mm (8")
∅38mm (1½")	Mid	100mm (4")	95mm (3¾")	200mm (8")

The information below shows the relationship between the pole, brackets and gliders/rollers. This will enable the correlation between pole heights and curtain drops to be easily calculated.

**SINGLE SYSTEM -  $\varnothing 38\text{mm}$  ( $1\frac{1}{2}$ "**

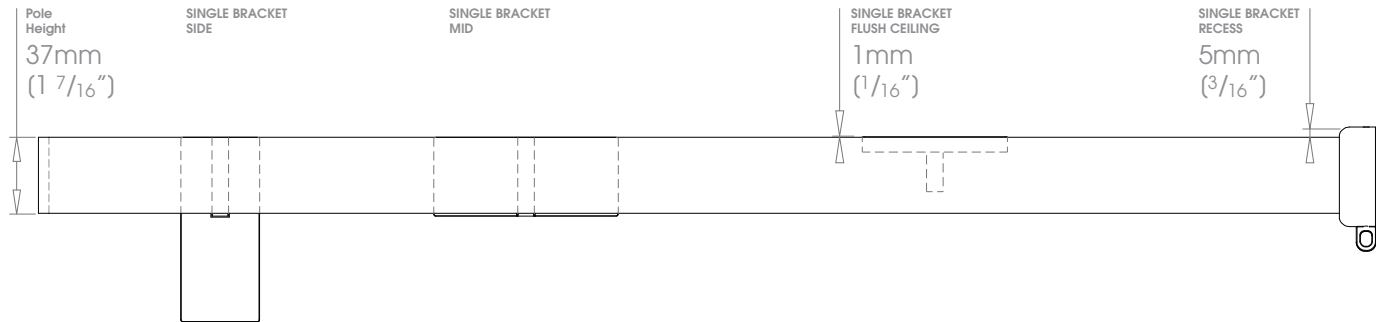

**DOUBLE SYSTEM - FRONT  $\varnothing 38\text{mm}$  ( $1\frac{1}{2}$ " BACK  $\varnothing 38\text{mm}$  ( $1\frac{1}{2}$ "**

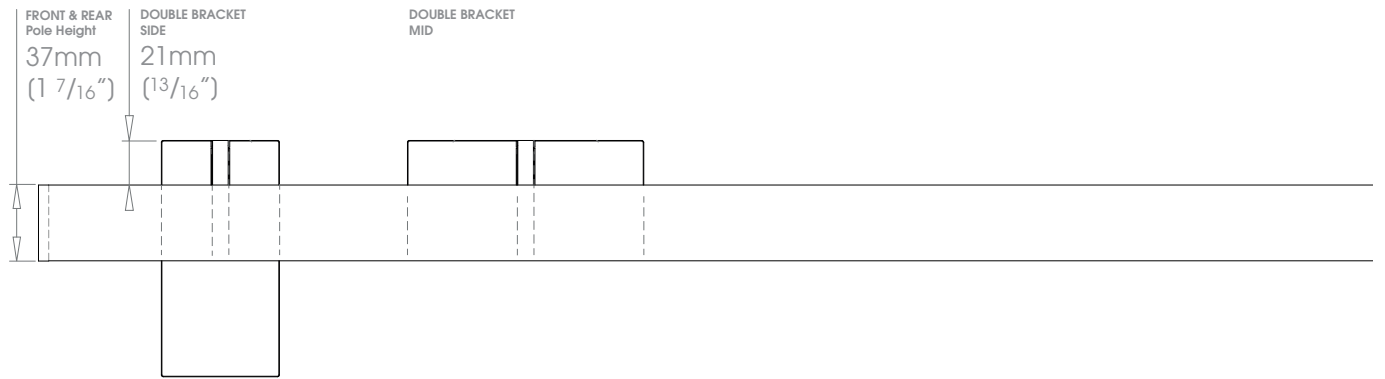

**PIN HOOK MEASUREMENT**

From bottom of the track

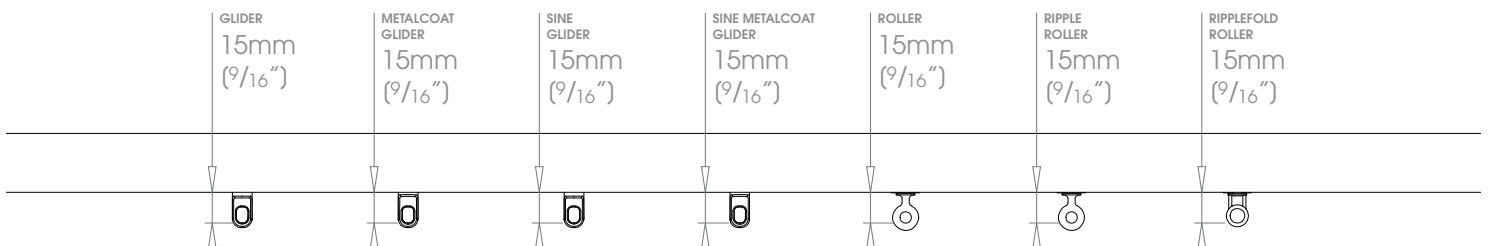

The information below shows the relationship between the pole, brackets and gliders/rollers. This will enable the correlation between pole heights and curtain drops to be easily calculated.

⚠ Partition Brackets can not be used around bay windows  
Motors must be positioned at opposite ends, as show below.

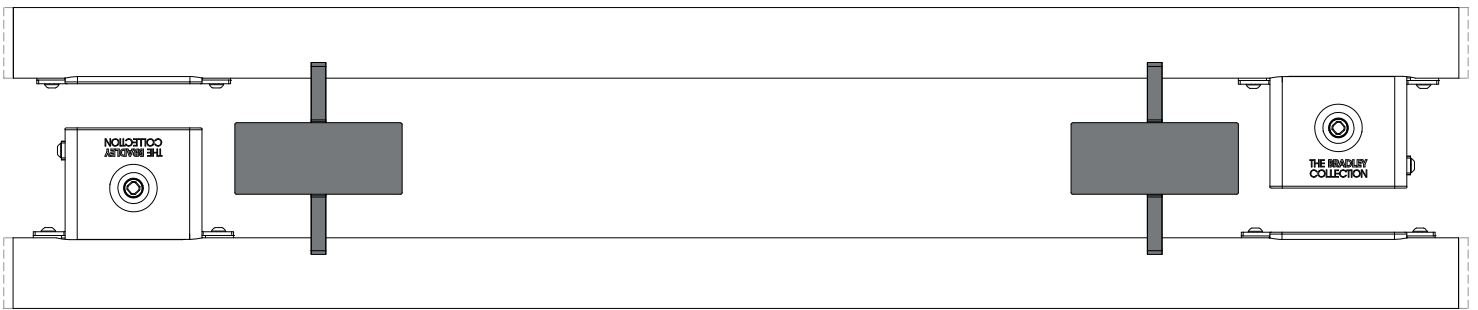

### DOUBLE PARTITION SYSTEM - FRONT $\varnothing 38\text{mm}$ (1 1/2") BACK $\varnothing 38\text{mm}$ (1 1/2")

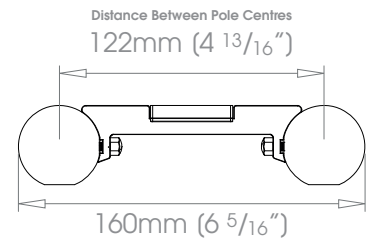
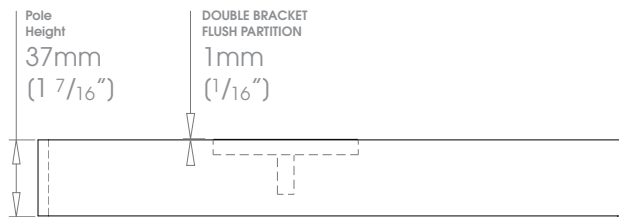

### PIN HOOK MEASUREMENT

From bottom of the track

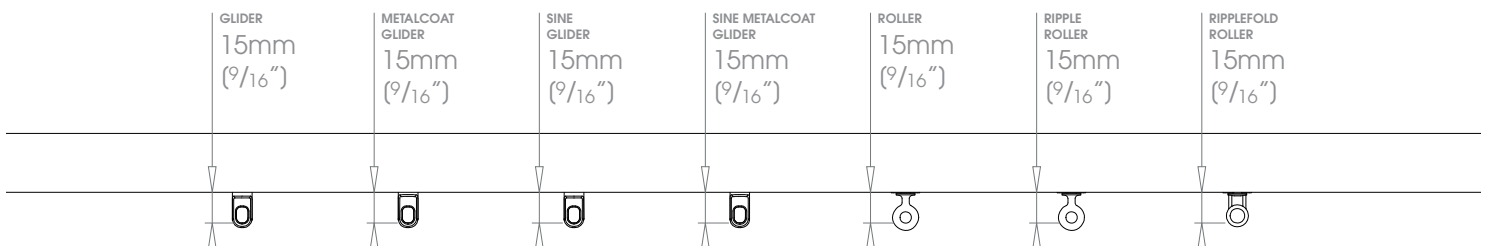

### CONFIGURATION

A looped driving belt runs around the motor and along the pole. This is attached to the pilot header which in turn is attached to the lead glider/roller.

#### DRIVE SYSTEM - SINGLE STACK →

On single stack systems the motor is always positioned on the stacking side. Allowing the motor to be hidden behind the curtain.



#### DRIVE SYSTEM - PAIR STACK →←

Pair stack curtains can have the motor positioned at either end of the pole. Curtains must be equal in length

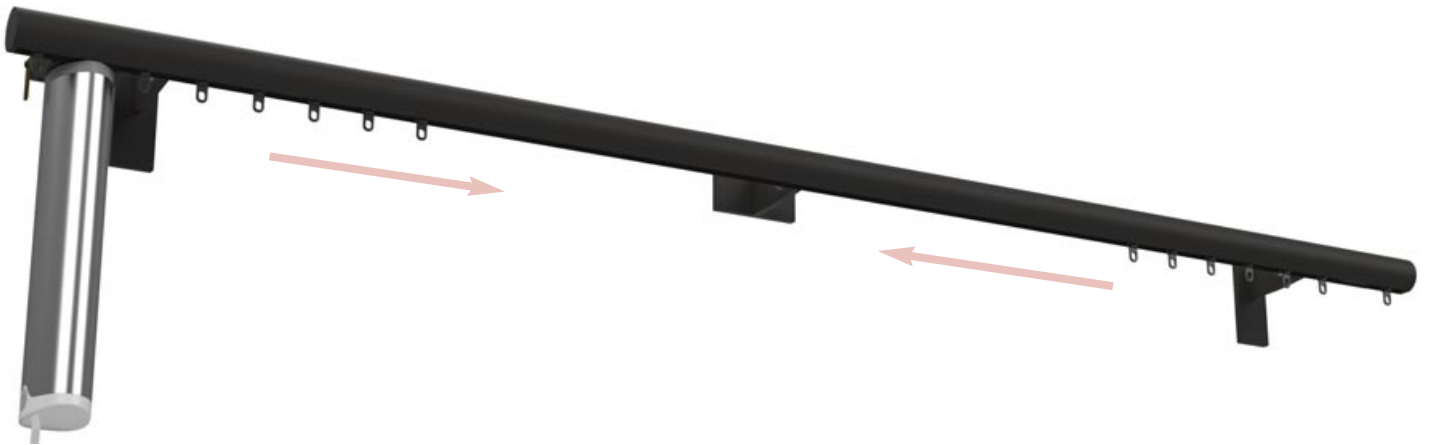

#### TWIN DRIVE SYSTEM - PAIR STACK →←

Twin Drive systems have the motor positioned at both ends of the pole. And are pair stack curtains only which can be different in length

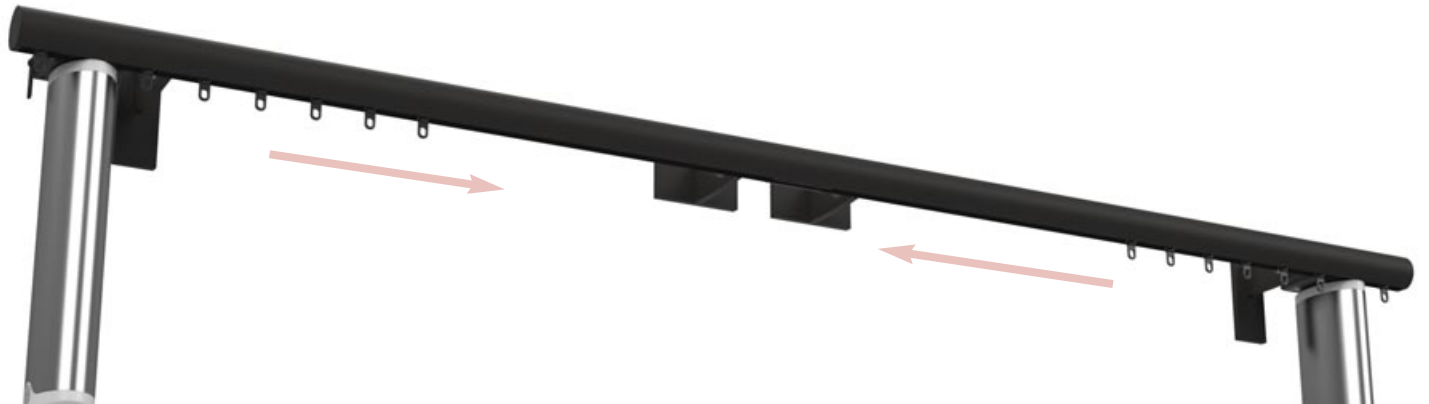



### MOTOR POSITIONING

Mains powered motor's needs to be positioned on same side of the window as the power supply.

Wiring diagrams are available on request

Motorised systems are unsuitable for use outdoors or in damp environments such as shower rooms and bathrooms.

#### ⚡ MAINS POWERED SYSTEMS

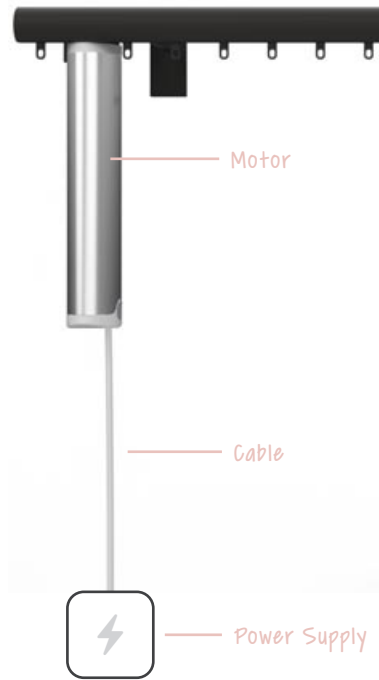

#### 🔋 BATTERY POWERED SYSTEMS SOMFY® MOVELITE & IRISMO ONLY

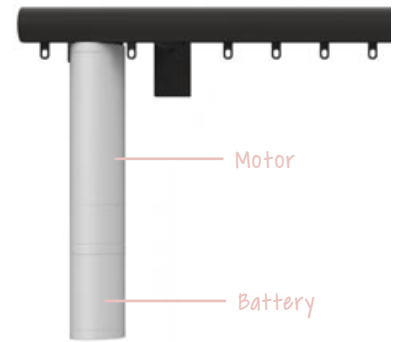

#### LEFT HAND MOTOR



#### RIGHT HAND MOTOR



#### TWIN MOTORS



CARTRIDGES

Cartridges are supplied to compliment system colour. See page 29 for details

MOTOR

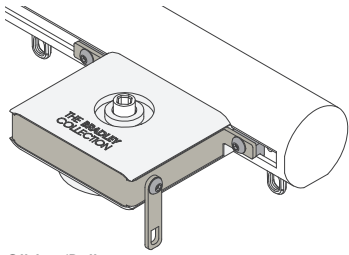

Gliders/Rollers

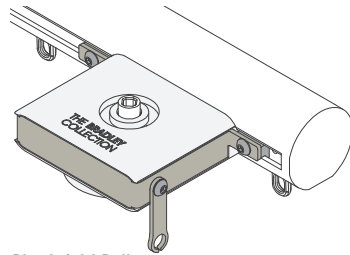

Ripplefold Rollers

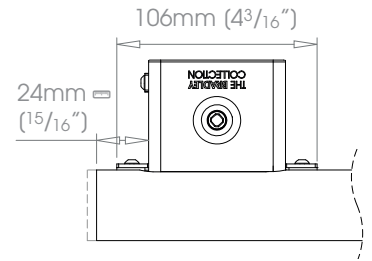

RETURN - SINGLE STACK →

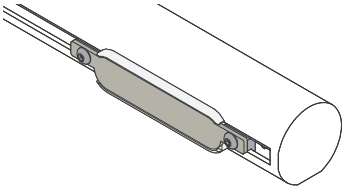

All Gliders/Rollers

RETURN - PAIR STACK →←

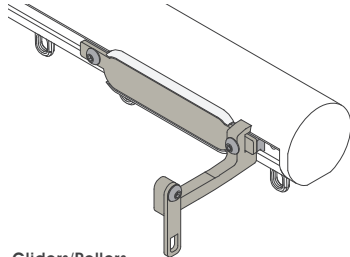

Gliders/Rollers

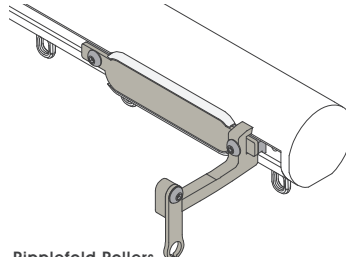

Ripplefold Rollers

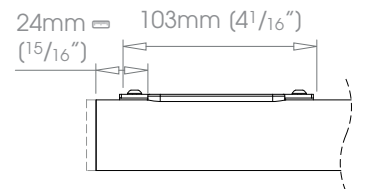

TWIN RETURN - PAIR STACK →←

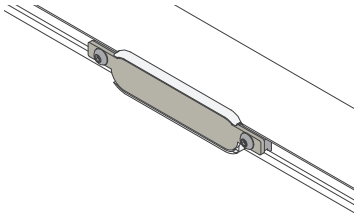

All Gliders/Rollers

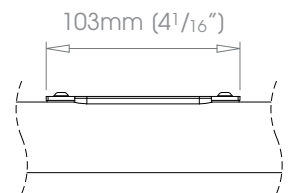

40mm (1 9/16") When Recess Brackets are specified

GLIDER ACCESS

Gliders can be added/removed by unscrewing the H-Plate

MOTOR END

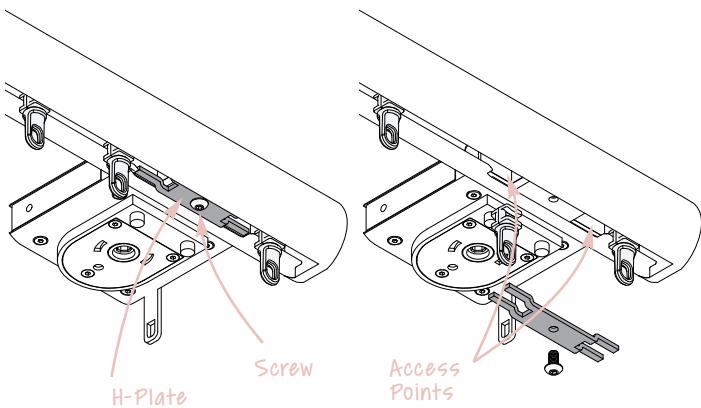

RETURN END

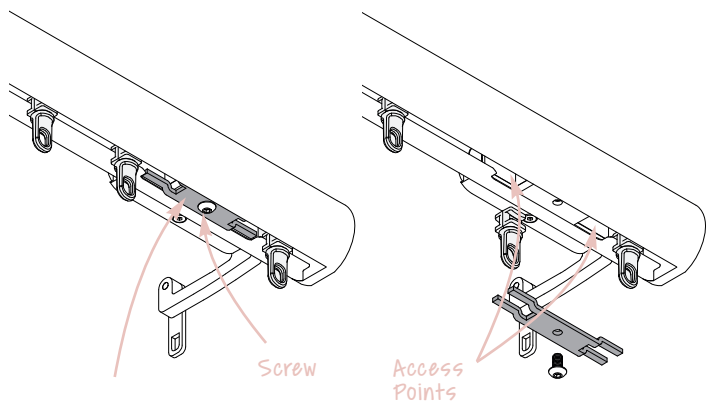

Systems will be supplied as per the diagrams below.

**DRIVE POLE SYSTEMS**  
**GLIDERS • METALCOAT GLIDERS**  
**ROLLERS**

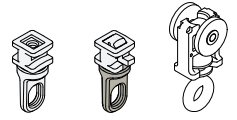

**SINGLE STACK →**

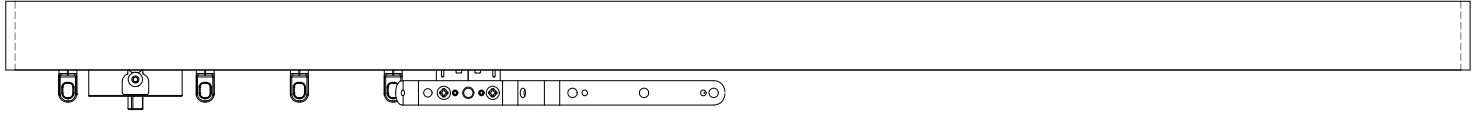

**SUPPLIED WITH**  
 1x Motor Cartridge with hook point for Standard Gliders/Rollers • 1x Return Cartridge • 1x Single stack Overlap Arm

**PAIR STACK →←**

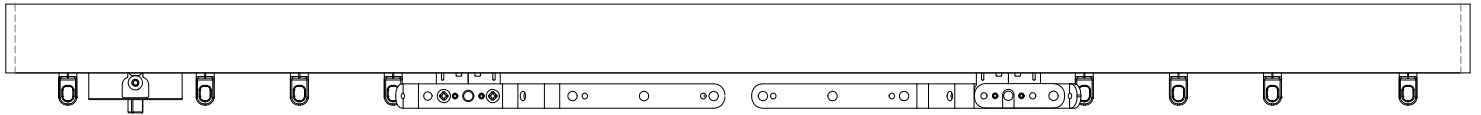

**SUPPLIED WITH**  
 1x Motor Cartridge with hook point for Standard Gliders/Rollers • 1x Return Cartridge with hook point for Standard Gliders/Rollers • 2x Pair stack Overlap Arm

**TWIN DRIVE - PAIR STACK →←**

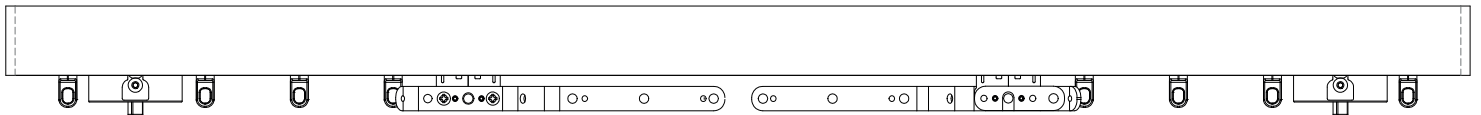

**SUPPLIED WITH**  
 2x Motor Cartridge with hook point for Standard Gliders/Rollers • 1x Twin Return Cartridge • 2x Pair stack Overlap Arm

 For Specification info on Overlap arms see page 23.

Systems will be supplied as per the diagrams below.

### DRIVE POLE SYSTEMS

SINE GLIDERS • METALCOAT SINE GLIDERS  
 RIPPLE ROLLERS • RIPPLEFOLD ROLLERS

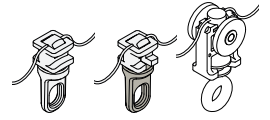

#### SINGLE STACK →

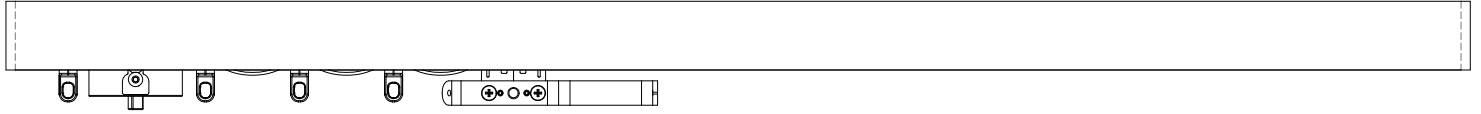

#### SUPPLIED WITH

1x Motor Cartridge with hook point for Gliders/Rollers • 1x Return Cartridge • 1x Sine/Ripple Overlap Arm

#### PAIR STACK →←



#### SUPPLIED WITH

1x Motor Cartridge with hook point for Gliders/Rollers • 1x Return Cartridge with hook point for Gliders/Rollers • 2x Sine/Ripple Butt Arm

#### TWIN DRIVE - PAIR STACK →←

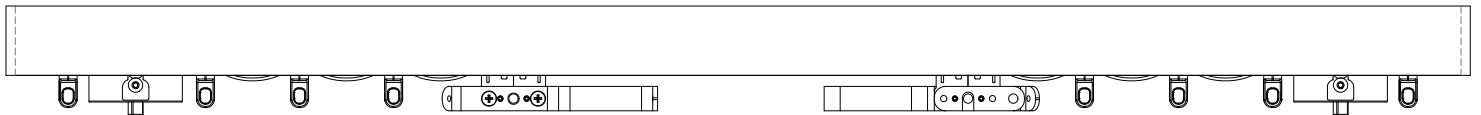

#### SUPPLIED WITH

2x Motor Cartridge with hook point for Gliders/Rollers • 1x Twin Return Cartridge • 2x Single stack Sine/Ripple Overlap Arm



For Specification info on Sine/Ripple arm see page 24

Systems will be supplied as per the diagrams below.

**DRIVE POLE SYSTEMS**  
**RIPPLEFOLD ROLLERS**

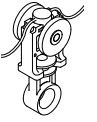

**SINGLE STACK →**



**SUPPLIED WITH**

1x Motor Cartridge with hook point for Ripplefold Rollers • 1x Return Cartridge • 1x Single stack Ripplefold Overlap Arm

**PAIR STACK →←**

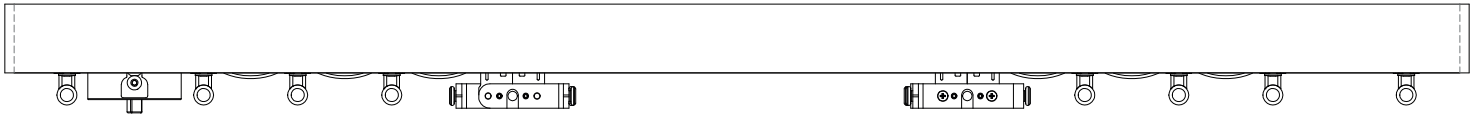

**SUPPLIED WITH**

1x Motor Cartridge with hook point for Ripplefold Rollers • 1x Return Cartridge with hook point for Ripplefold Rollers • 2x Ripplefold Butt Arm

**TWIN DRIVE - PAIR STACK →←**



**SUPPLIED WITH**

2x Motor Cartridge with hook point for Ripplefold Rollers • 1x Twin Return Cartridge • 2x Single stack Ripplefold Overlap Arm



For Specification info on Ripplefold arms see page 25

### STACK SIZES

This is the area where the curtains hang against the wall when they are pulled open. by covering the wall and not the glass, during the day, it allows more light into the room. Allow approximately 30% of the length of the track for curtain stacking, very full curtains (e.g. pencil pleat) will need more space than flatter ones. lined and interlined curtains will also require more stacking space than unlined.

SINGLE STACK →



PAIR STACK →←



## STANDARD HEADINGS

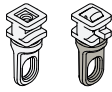

### GLIDERS • METALCOAT GLIDERS

Gliders are suitable for most installations. one glider is specified for every 100mm (4").

**Glider Colour Options:** Gypsum • Anthracite

**Metalcoat Colour Options:** System Colour © • Brushed Nickel

### STANDARD

Fullness 1.5

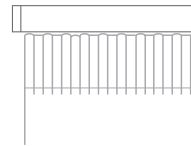

### PINCH PLEAT

Fullness 2.0



### PENCIL PLEAT

Fullness 2.5 (Heavy)

Fullness 2.5 (Voiles)

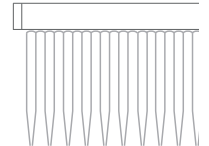

Pencil pleats will have a larger stack back and performance may be reduced

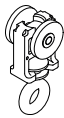

### ROLLERS

Rollers are preferred for heavy drapery. one roller is specified for every 100mm (4").

**Roller Colour Options:** White • Black

## SINE & RIPPLE HEADINGS

Sine & Ripple headings are a simple S folded heading system consisting of rollers spaced by a cord and a special pocketed header tape that is sewn onto a flat panel curtain.track. it offers an elegant, contemporary look.

- Ideal for both residential and commercial settings.
- Drapery is constructed special pocketed header tape that is sewn onto a flat panel curtain
- Hooks are fitted to header tape at a set spacing shown below creating the ripple effect
- Fullness can be adjusted by changing the hook spacing.

### SINE • RIPPLE

Fullness 2.3

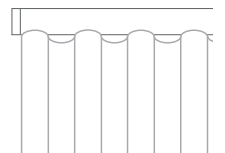

### FABRIC SUITABILITY

There is no standard test that will indicate whether a fabric is suitable for wave style. However, experience suggests it is normally suitable for:

✓ Voiles • Lined cotton • Interlined Silk • Blackout lining

The soft curves of Wave do not lend themselves to:

✗ Stiff fabrics • Heavy embroidery • Irregular vertical stripes • Metallic threads

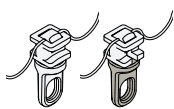

### SINE GLIDERS • METALCOAT SINE GLIDERS

Gliders are suitable for most installations.

**Sine Pitch:** 80mm (3 1/8")

**Sine Glider Colour Options:** Gypsum • Anthracite

**Metalcoat Sine Colour Options:** System Colour © • Brushed Nickel



### RIPPLE ROLLERS

Rollers are preferred for heavy drapery.

**Ripple Pitch:** 80mm (3 1/8")

**Ripple Roller Colour Options:** White • Black

Glider • Roller Spacing	Curtain Hook Spacing	Approx. Curtain Fullness	Stack Depth per 1M (39 3/8") of pole	Min Bracket Projection
80mm (3 1/8")	160mm (6 3/16")	2.3	180mm (7 1/16")	100mm (4")

## RIPPLEFOLD HEADING

Ripplefold pleat style is named for the soft, consistent ripples created by the drapery as it hangs from the track. It offers an elegant, contemporary look.

- Ideal for both residential and commercial settings.
- Drapery is constructed with snap tape (graber® is required) that allows the drapery to be snapped directly to the auxillary carriers on the track.
- Fullness of the drapery is determined by the spacing of the carriers in the track. the higher the fullness factor, the more full the draperies appear.
- 3 fullness factors are available

RIPPLEFOLD

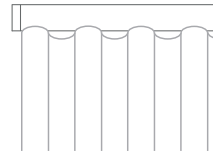

### RIPPLEFOLD ROLLERS

Rollers are preferred for heavy drapery.

**Ripplefold® Fullness:** 80% • 100% • 120%

**Roller Colour Options:** White

	Roller-Cord Spacing	Curtain Fullness	Stack Depth per 1M (39 3/8") of pole	Min Bracket Projection
	60mm (2 3/8")	80%	270mm (10 5/8")	100mm (4")
	55mm (2 1/8")	100%	310mm (12 3/16")	100mm (4")
	45mm (1 3/4")	120%	360mm (14 3/16")	100mm (4")

**Roller pendants are pre-installed into the pole**  
**Curtains need to be offered up to pole and snapped into place**



Different types of fabric have widely differing weights. The type of curtain heading used (see below) will determine the fullness of the fabric used: this can be anything from 1.5 x the width of the pole to 3.0 x pole width.

The chart below assumes 100% fullness (2.0 x width of the pole) the weights are very approx and can vary for many reasons. Always check the expected and final total curtain weight with the curtain maker. Based on 1200mm (48") fabric width

Curtain Type	Width↓ /Drop→	1m (3.5')	2m (7')	3m (10.5')	4m (14')	5m (16.5')	6m (20')
Print Cotton (Light)	1m (3.5')	0.8kg (1.8lb)	1.7kg (3.7lb)	2.5kg (5.5lb)	3.4kg (7.4lb)	4.2kg (9.2lb)	5.0kg (11.1lb)
	2m (7')	1.3kg (2.8lb)	2.5kg (5.5lb)	3.8kg (8.3lb)	5kg (11.1lb)	6.3kg (13.9lb)	7.6kg (16.6lb)
	3m (10')	1.7kg (3.7lb)	3.4kg (7.4lb)	5kg (11.1lb)	6.7kg (14.8lb)	8.4kg (18.5lb)	10kg (22lb)
Linen (Medium)	1m (3.5')	1.1kg (2.3lb)	2.1kg (4.6lb)	3.2kg (6.9lb)	4.2kg (9.2lb)	5.3kg (11.6lb)	6.3kg (13.9lb)
	2m (7')	1.6kg (3.5lb)	3.2kg (6.9lb)	4.7kg (10.4lb)	6.3kg (13.9lb)	7.9kg (17.3lb)	9.5kg (20.8lb)
	3m (10')	2.1kg (4.6lb)	4.2kg (9.2lb)	6.3kg (13.9lb)	8.4kg (18.5lb)	10.5kg (23.1lb)	12.6kg (27.7lb)
Velvet (Heavy)	1m (3.5')	1.5kg (3.2lb)	3.2kg (6.5lb)	4.4kg (9.7lb)	5.9kg (12.9lb)	7.4kg (16.2lb)	8.8kg (19.4lb)
	2m (7')	2.2kg (4.9lb)	4.4kg (9.7lb)	6.7kg (12.6lb)	8.8kg (19.4lb)	11kg (24.3lb)	13.2kg (22lb)
	3m (10')	2.9kg (6.5lb)	5.9kg (12.9lb)	8.8kg (19.4lb)	11.8kg (26lb)	14.7kg (32.2lb)	17.6kg (39lb)

**GLIDERS • METALCOAT GLIDERS • SINE GLIDERS • METALCOAT SINE GLIDERS**

Gliders One glider is specified for every 100mm (4").

Sine Gliders 80mm (3 1/8") spacing between the gliders.

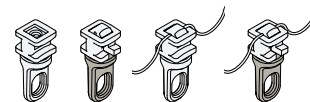

Maximum weight recommendations for all standard curtain types using Gliders are defined to ensure safe and proper function of the system. These must be adhered to. See table below for details of all options.

**!** Bends will considerably reduce the load bearing capability of any system.

Motor Type	System Width	Straight		1 Bend Bay		2 Bend Bay		4 Bend Bay		Curved Bay	
		Single Drive	Twin Drive	Single Drive	Twin Drive	Single Drive	Twin Drive	Twin Drive	Single Drive		
		Single Stack → Pair Stack →←	Pair Stack →←	Single Stack → Pair Stack →←	Pair Stack →←	Single Stack → Pair Stack →←	Pair Stack →←	Pair Stack →←	Pair Stack →←		
⚡ LUTRON D105 MOTOR	2m (78 3/8")	24kg (53lb)	48kg (106lb)	18kg (39lb)	36kg (79lb)	—	—	—	—	—	
	4m (157 1/2")	38kg (85lb)	76kg (167lb)	20kg (44lb)	40kg (88lb)	—	—	—	—	—	
	6m (236 1/4")	26kg (70lb)	52kg (140lb)	18kg (39lb)	36kg (79lb)	—	—	—	—	—	
	8m (314 15/16")	18kg (40lb)	36kg (80lb)	16kg (35lb)	32kg (70lb)	—	—	—	—	—	
	10m (393 11/16")	14kg (31lb)	28kg (62lb)	13kg (29lb)	26kg (58lb)	—	—	—	—	—	
⚡ LUTRON D145 MOTOR	2m (78 3/8")	24kg (53lb)	48kg (106lb)	24kg (53lb)	48kg (106lb)	16kg (35lb)	32kg (70lb)	32kg (70lb)	16kg (35lb)	—	
	4m (157 1/2")	53kg (116lb)	106kg (232lb)	32kg (70lb)	64kg (140lb)	20kg (44lb)	40kg (88lb)	40kg (88lb)	20kg (44lb)	—	
	6m (236 1/4")	44kg (103lb)	88kg (206lb)	34kg (75lb)	68kg (150lb)	20kg (44lb)	40kg (88lb)	40kg (88lb)	20kg (44lb)	—	
	8m (314 15/16")	36kg (79lb)	72kg (159lb)	32kg (70lb)	64kg (140lb)	18kg (39lb)	36kg (79lb)	36kg (79lb)	18kg (39lb)	—	
	10m (393 11/16")	32kg (70lb)	64kg (140lb)	31kg (68lb)	62kg (132lb)	16kg (35lb)	32kg (70lb)	32kg (70lb)	16kg (35lb)	—	
⚡ LUTRON D175 MOTOR	2m (78 3/8")	24kg (53lb)	48kg (106lb)	24kg (53lb)	48kg (106lb)	24kg (53lb)	48kg (106lb)	48kg (106lb)	24kg (53lb)	—	
	4m (157 1/2")	47kg (104lb)	94kg (208lb)	43kg (95lb)	86kg (190lb)	31kg (68lb)	62kg (132lb)	62kg (132lb)	31kg (68lb)	—	
	6m (236 1/4")	63kg (139lb)	126kg (278lb)	47kg (104lb)	94kg (208lb)	43kg (95lb)	86kg (190lb)	86kg (190lb)	43kg (95lb)	—	
	8m (314 15/16")	56kg (123lb)	112kg (246lb)	49kg (108lb)	98kg (216lb)	33kg (73lb)	66kg (146lb)	66kg (146lb)	33kg (73lb)	—	
	10m (393 11/16")	53kg (117lb)	112kg (246lb)	49kg (108lb)	98kg (216lb)	33kg (73lb)	66kg (146lb)	66kg (146lb)	33kg (73lb)	—	
⚡ SOMFY GLYDEA ULTRA 60E MOTOR	2m (78 3/8")	48kg (106lb)	96kg (212lb)	36kg (79lb)	72kg (159lb)	28kg (62lb)	56kg (123lb)	56kg (123lb)	28kg (62lb)	—	
	4m (157 1/2")	48kg (106lb)	96kg (212lb)	36kg (79lb)	72kg (159lb)	28kg (62lb)	56kg (123lb)	56kg (123lb)	28kg (62lb)	—	
	6m (236 1/4")	48kg (106lb)	96kg (212lb)	36kg (79lb)	72kg (159lb)	28kg (62lb)	56kg (123lb)	56kg (123lb)	28kg (62lb)	—	
	8m (314 15/16")	48kg (106lb)	96kg (212lb)	36kg (79lb)	72kg (159lb)	24kg (53lb)	48kg (106lb)	48kg (106lb)	25kg (55lb)	—	
	10m (393 11/16")	48kg (106lb)	96kg (212lb)	36kg (79lb)	72kg (159lb)	25kg (55lb)	50kg (110lb)	50kg (110lb)	—	—	
🔋 SOMFY IRISMO 45 WF MOTOR	2m (78 3/8")	36kg (79lb)	72kg (159lb)	36kg (79lb)	72kg (159lb)	28kg (62lb)	56kg (123lb)	56kg (123lb)	28kg (62lb)	—	
	4m (157 1/2")	36kg (79lb)	72kg (159lb)	36kg (79lb)	72kg (159lb)	28kg (62lb)	56kg (123lb)	56kg (123lb)	22kg (48lb)	—	
	6m (236 1/4")	36kg (79lb)	72kg (159lb)	36kg (79lb)	72kg (159lb)	24kg (53lb)	48kg (106lb)	48kg (106lb)	16kg (35lb)	—	
	8m (314 15/16")	36kg (79lb)	72kg (159lb)	32kg (70lb)	64kg (140lb)	20kg (44lb)	40kg (88lb)	40kg (88lb)	—	—	
	10m (393 11/16")	36kg (79lb)	72kg (159lb)	28kg (62lb)	56kg (123lb)	16kg (35lb)	32kg (70lb)	32kg (70lb)	—	—	
⚡ SOMFY MOVELITE 35 MOTOR	2m (78 3/8")	28kg (62lb)	56kg (123lb)	28kg (62lb)	56kg (123lb)	12kg (26lb)	25kg (55lb)	25kg (55lb)	28kg (62lb)	—	
	4m (157 1/2")	28kg (62lb)	56kg (123lb)	24kg (53lb)	48kg (106lb)	10kg (22lb)	20kg (44lb)	20kg (44lb)	18kg (39lb)	—	
	6m (236 1/4")	28kg (62lb)	56kg (123lb)	25kg (55lb)	50kg (110lb)	8kg (17.5lb)	16kg (35lb)	16kg (35lb)	8kg (17.5lb)	—	
	8m (314 15/16")	28kg (62lb)	56kg (123lb)	22kg (48lb)	44kg (96lb)	—	—	—	—	—	
	10m (393 11/16")	28kg (62lb)	56kg (123lb)	20kg (44lb)	40kg (88lb)	—	—	—	—	—	
🔋 SOMFY MOVELITE 35 WF MOTOR	2m (78 3/8")	28kg (62lb)	56kg (123lb)	<b>!</b> Motor not suitable for use within bay windows						—	—
	4m (157 1/2")	28kg (62lb)	56kg (123lb)							—	—
	6m (236 1/4")	28kg (62lb)	56kg (123lb)							—	—
	8m (314 15/16")	—	—							—	—
	10m (393 11/16")	—	—							—	—
⚡ SILENT GLISS 9060 MOTOR	2m (78 3/8")	20kg (44lb)	40kg (88lb)	20kg (44lb)	40kg (88lb)	20kg (44lb)	40kg (88lb)	40kg (88lb)	20kg (44lb)	—	
	4m (157 1/2")	36kg (79lb)	72kg (159lb)	28kg (62lb)	56kg (123lb)	24kg (53lb)	48kg (106lb)	48kg (106lb)	24kg (53lb)	—	
	6m (236 1/4")	36kg (79lb)	72kg (159lb)	28kg (62lb)	56kg (123lb)	24kg (53lb)	48kg (106lb)	48kg (106lb)	24kg (53lb)	—	
	8m (314 15/16")	40kg (88lb)	80kg (176lb)	32kg (70lb)	64kg (140lb)	24kg (53lb)	48kg (106lb)	48kg (106lb)	24kg (53lb)	—	
	10m (393 11/16")	52kg (115lb)	104kg (230lb)	28kg (62lb)	56kg (123lb)	20kg (44lb)	40kg (88lb)	40kg (88lb)	—	—	

**ROLLERS • RIPPLE ROLLERS • RIPPLEFOLD ROLLERS**

Rollers One roller is specified for every 100mm (4").

Ripple Rollers 80mm (3 1/8") spacing between the rollers.

Ripplefold Rollers Fullness options 80% • 100% • 120%

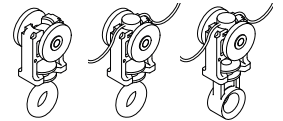

Maximum weight recommendations for all standard curtain types using Gliders are defined to ensure safe and proper function of the system. These must be adhered to. See table below for details of all options.

**! Roller options not suitable for use on 38mm (1 1/2") bay/curved poles**

Motor Type	System Width	Straight		1 Bend Bay		2 Bend Bay		4 Bend Bay		Curved Bay
		Single Drive	Twin Drive	Single Drive	Twin Drive	Single Drive	Twin Drive	Twin Drive	Single Drive	
		Single Stack → Pair Stack →←	Pair Stack →←	Single Stack → Pair Stack →←	Pair Stack →←	Single Stack → Pair Stack →←	Pair Stack →←	Pair Stack →←	Pair Stack →←	
⚡ LUTRON D105 MOTOR	2m (78 3/8")	30kg (65lb)	60kg (130lb)	—	—	—	—	—	—	—
	4m (157 1/2")	48kg (105lb)	96kg (210lb)	—	—	—	—	—	—	—
	6m (236 1/4")	32kg (70lb)	64kg (140lb)	—	—	—	—	—	—	—
	8m (314 15/16")	23kg (50lb)	46kg (100lb)	—	—	—	—	—	—	—
	10m (393 11/16")	18kg (40lb)	36kg (80lb)	—	—	—	—	—	—	—
⚡ LUTRON D145 MOTOR	2m (78 3/8")	30kg (65lb)	60kg (130lb)	—	—	—	—	—	—	—
	4m (157 1/2")	66kg (145lb)	122kg (290lb)	—	—	—	—	—	—	—
	6m (236 1/4")	55kg (120lb)	110kg (240lb)	—	—	—	—	—	—	—
	8m (314 15/16")	45kg (100lb)	90kg (200lb)	—	—	—	—	—	—	—
	10m (393 11/16")	40kg (90lb)	80kg (180lb)	—	—	—	—	—	—	—
⚡ LUTRON D175 MOTOR	2m (78 3/8")	30kg (65lb)	60kg (130lb)	—	—	—	—	—	—	—
	4m (157 1/2")	59kg (130lb)	118kg (260lb)	—	—	—	—	—	—	—
	6m (236 1/4")	79kg (175lb)	158kg (350lb)	—	—	—	—	—	—	—
	8m (314 15/16")	70kg (155lb)	140kg (310lb)	—	—	—	—	—	—	—
	10m (393 11/16")	66kg (145lb)	122kg (290lb)	—	—	—	—	—	—	—
⚡ SOMFY GLYDEA ULTRA 60E MOTOR	2m (78 3/8")	60kg (132lb)	120kg (264lb)	—	—	—	—	—	—	—
	4m (157 1/2")	60kg (132lb)	120kg (264lb)	—	—	—	—	—	—	—
	6m (236 1/4")	60kg (132lb)	120kg (264lb)	—	—	—	—	—	—	—
	8m (314 15/16")	60kg (132lb)	120kg (264lb)	—	—	—	—	—	—	—
	10m (393 11/16")	60kg (132lb)	120kg (264lb)	—	—	—	—	—	—	—
🔋 SOMFY IRISMO 45 WF MOTOR	2m (78 3/8")	45kg (99lb)	90kg (198lb)	—	—	—	—	—	—	—
	4m (157 1/2")	45kg (99lb)	90kg (198lb)	—	—	—	—	—	—	—
	6m (236 1/4")	45kg (99lb)	90kg (198lb)	—	—	—	—	—	—	—
	8m (314 15/16")	45kg (99lb)	90kg (198lb)	—	—	—	—	—	—	—
	10m (393 11/16")	45kg (99lb)	90kg (198lb)	—	—	—	—	—	—	—
⚡ SOMFY MOVELITE 35 MOTOR	2m (78 3/8")	35kg (77lb)	70kg (154lb)	—	—	—	—	—	—	—
	4m (157 1/2")	35kg (77lb)	70kg (154lb)	—	—	—	—	—	—	—
	6m (236 1/4")	35kg (77lb)	70kg (154lb)	—	—	—	—	—	—	—
	8m (314 15/16")	—	—	—	—	—	—	—	—	—
	10m (393 11/16")	—	—	—	—	—	—	—	—	—
🔋 SOMFY MOVELITE 35 WF MOTOR	2m (78 3/8")	35kg (77lb)	70kg (154lb)	—	—	—	—	—	—	—
	4m (157 1/2")	35kg (77lb)	70kg (154lb)	—	—	—	—	—	—	—
	6m (236 1/4")	35kg (77lb)	70kg (154lb)	—	—	—	—	—	—	—
	8m (314 15/16")	—	—	—	—	—	—	—	—	—
	10m (393 11/16")	—	—	—	—	—	—	—	—	—
⚡ SILENT GLISS 9060 MOTOR	2m (78 3/8")	25kg (55lb)	50kg (110lb)	—	—	—	—	—	—	—
	4m (157 1/2")	45kg (99lb)	90kg (198lb)	—	—	—	—	—	—	—
	6m (236 1/4")	45kg (99lb)	90kg (198lb)	—	—	—	—	—	—	—
	8m (314 15/16")	50kg (110lb)	100kg (220lb)	—	—	—	—	—	—	—
	10m (393 11/16")	65kg (143lb)	130kg (286lb)	—	—	—	—	—	—	—

Standard Overlap Arm

---

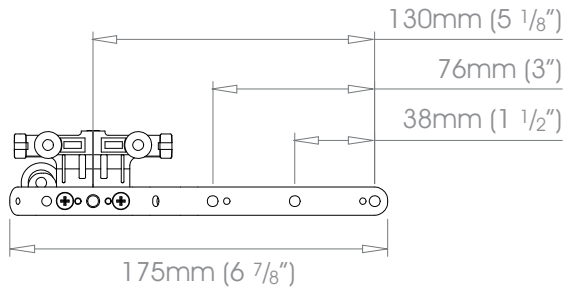

Supplied as standard on Single & Pair Stack Systems with Rollers

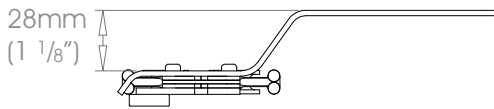

Single Stack → Ripple Arm

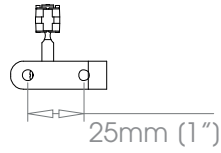
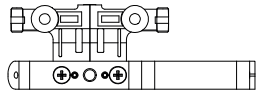
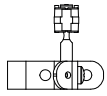

Supplied on single stack systems with Sine Gliders/Ripple Rollers

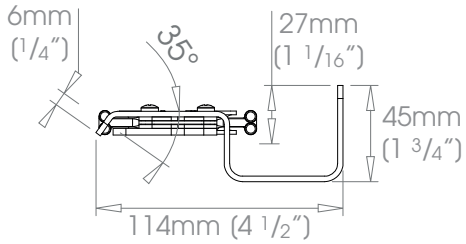

Pair Stack →← Ripple Butt Arm

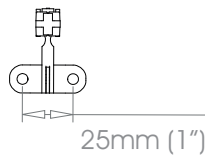
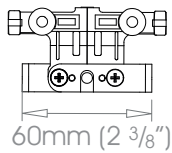
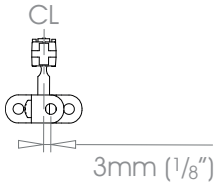

Supplied on pair stack systems with Sine Gliders/Ripple Rollers

Single Stack → Ripplefold Arm

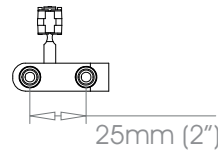
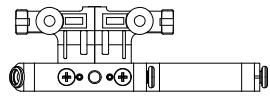
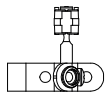

Supplied on single stack systems with Ripplefold Rollers

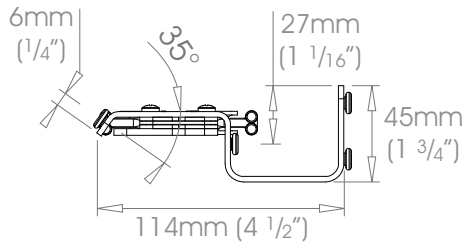

Pair Stack →← Ripplefold Butt Arm

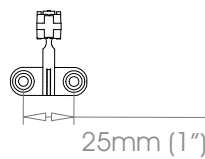
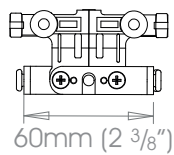
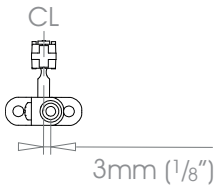

Supplied on pair stack systems with Ripplefold Rollers



All poles and components may be specified in this stunning palette of colours and finishes, with a choice of coat options throughout.

**COAT OPTIONS**



**SHADES**

A superb selection of opaque colours, all available in a choice of Matte, Satin or Gloss finish.

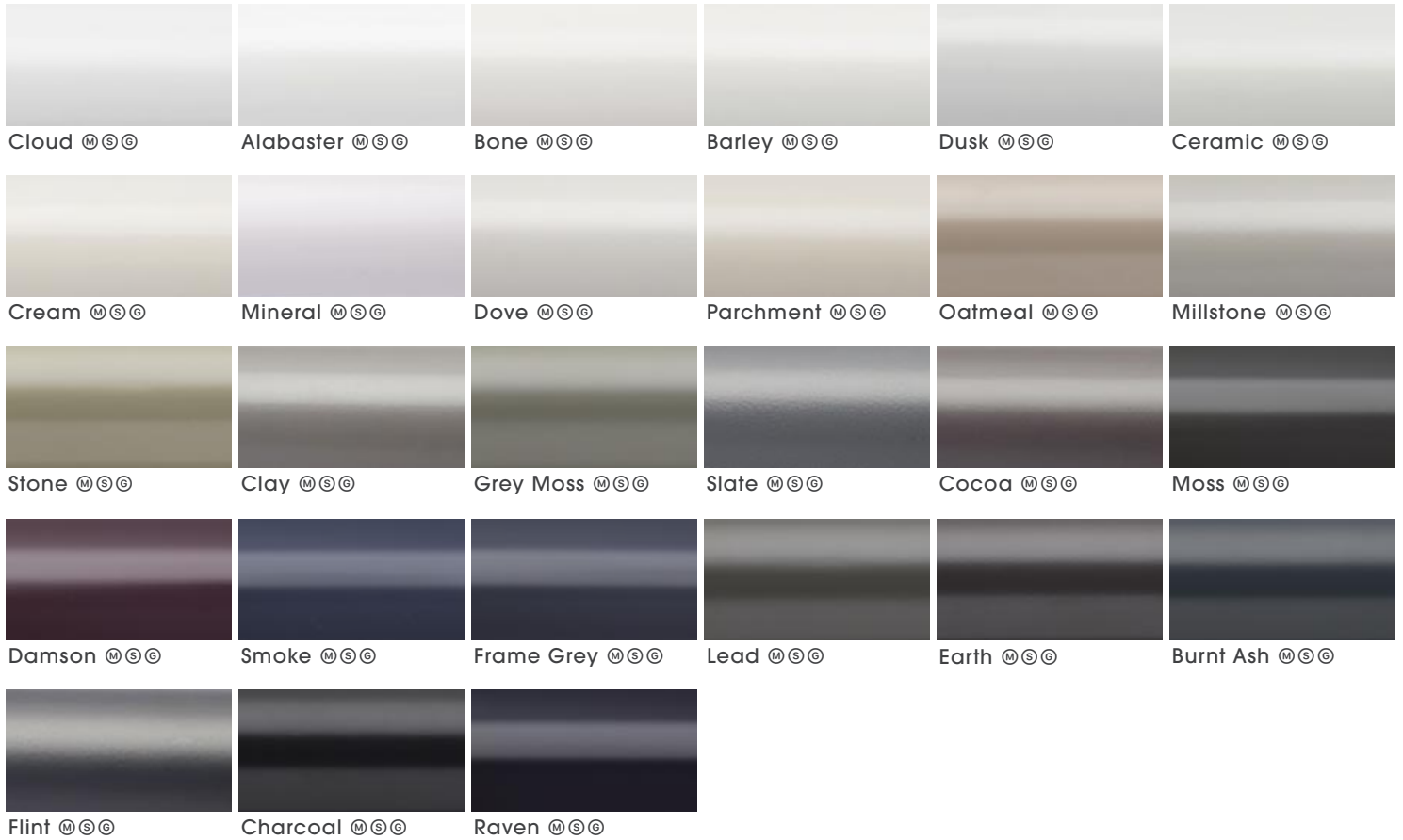



All poles and components may be specified in this stunning palette of colours and finishes, with a choice of coat options throughout.

**COAT OPTIONS**

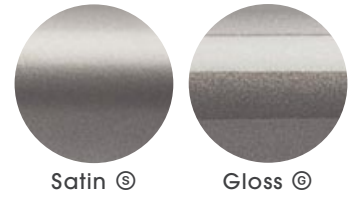

**METALLICS**

High metallic fleck coatings with most available in Satin and Gloss sheen levels.



**ANODIC METALS**

A flat metal colour group, with an anodised style surface texture.

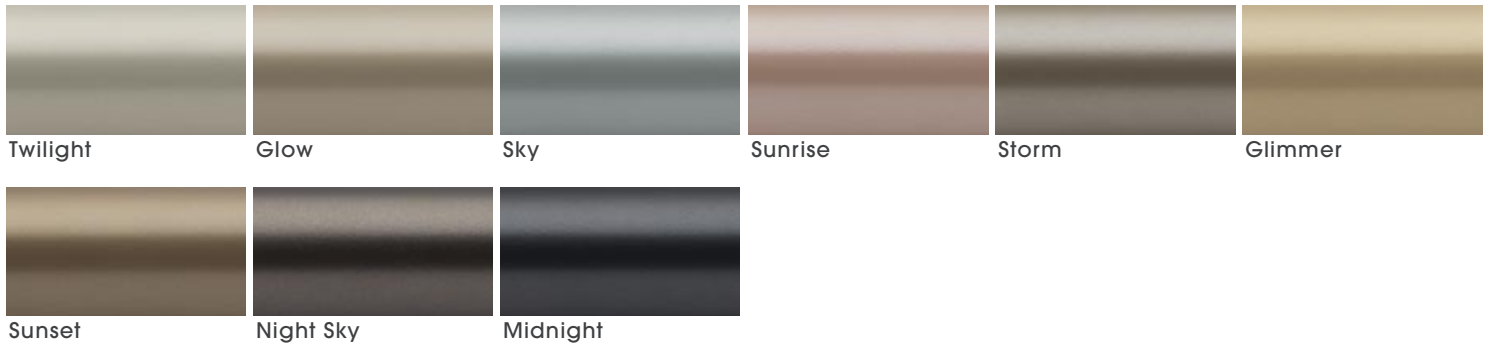

**CUSTOM FINISHES**

Can be specified from RAL K7 finish chart, subject to a per colour upcharge, which covers up to five poles. See price list for further details





**COLOUR MATCHING**

A colour matching service is offered, to match your scheme of fittings perfectly . See price list for further details

Motor & Return Cartridges & Metalcoat Gliders (where specified) will be supplied in either Gypsum or Anthracite to compliment the chosen finish. See table below

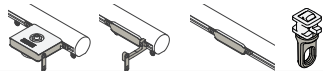
**Coat Options** Matte® • Satin® • Gloss®

System Finish	Gypsum 	Anthracite 
Alabaster®®®	✓	
Antique Brass®®		✓
Barley®®®	✓	
Bone®®®	✓	
Burnt Ash®®®		✓
Bronzed®®		✓
Ceramic®®®	✓	
Champagne®®		✓
Charcoal®®®		✓
Clay®®®		✓
Cloud®®®	✓	
Cocoa®®®		✓
Cognac®®		✓
Cream®®®	✓	
Damson®®®		✓
Dove®®®	✓	
Dusk®®®	✓	
Earth®®®		✓
Flint®®®		✓
Frame Grey®®®		✓
Glimmer		✓
Glow		✓
Gold®®		✓
Grey Moss®®®		✓
Gunmetal®®		✓
Lead®®®		✓
Midnight		✓
Millstone®®®		✓
Mineral®®®	✓	
Moss®®®		✓
Night Sky		✓
Oatmeal®®®		✓
Parchment®®®	✓	
Pewter®®		✓
Platinum®®		✓
Raven®®®		✓
Slate®®®		✓
Sky		✓
Smoke®®®		✓
Stone®®®		✓
Storm		✓
Sunrise		✓
Sunset		✓
Twilight		✓





⚠ The seamless finial is an integral part of the pole.  
 If this is selected optional finial details cannot be added at a later date.

- FINISHES** Shades @@@ Cloud • Alabaster • Bone • Barley • Dusk • Ceramic • Cream • Mineral • Dove • Parchment • Oatmeal • Millstone • Stone • Clay • Grey Moss  
 Slate • Cocoa • Moss • Damson • Smoke • Frame Grey • Lead • Earth • Burnt Ash • Flint • Charcoal • Raven  
 Coat Options **Metallics** @@ Platinum • Champagne • Gold • Cognac • Antique Brass • Gunmetal • Pewter • Bronzed  
**Anodic Metals** Twilight • Glow • Sky • Sunrise • Storm • Glimmer • Sunset • Night Sky • Midnight  
 Matte @ **Custom** See page 29 for details  
 Satin @  
 Gloss @

ø38mm (1 1/2")

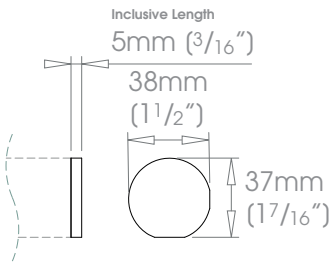



ⓘ Can only be added at point of order  
 Finial detail cannot be used with Flush Ceiling Brackets / Flush Partition Brackets

**FINISHES** Shades @@@ Cloud • Alabaster • Bone • Barley • Dusk • Ceramic • Cream • Mineral • Dove • Parchment • Oatmeal • Millstone • Stone • Clay • Grey Moss  
 Slate • Cocoa • Moss • Damson • Smoke • Frame Grey • Lead • Earth • Burnt Ash • Flint • Charcoal • Raven  
 Coat Options **Metallics** @@ Platinum • Champagne • Gold • Cognac • Antique Brass • Gunmetal • Pewter • Bronzed  
**Anodic Metals** Twilight • Glow • Sky • Sunrise • Storm • Glimmer • Sunset • Night Sky • Midnight  
 Matte @ **Custom** See page 29 for details  
 Satin @  
 Gloss @

ø38mm (1 1/2")

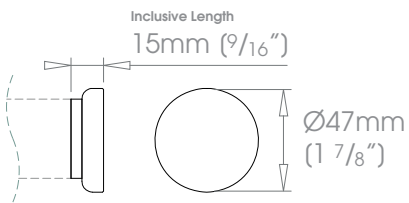



ⓘ Can only be added at point of order  
 Finial detail cannot be used with Flush Ceiling Brackets / Flush Partition Brackets

**FINISHES** Shades @@@ Cloud • Alabaster • Bone • Barley • Dusk • Ceramic • Cream • Mineral • Dove • Parchment • Oatmeal • Millstone • Stone • Clay • Grey Moss  
 Slate • Cocoa • Moss • Damson • Smoke • Frame Grey • Lead • Earth • Burnt Ash • Flint • Charcoal • Raven  
 Coat Options **Metallics** @@ Platinum • Champagne • Gold • Cognac • Antique Brass • Gunmetal • Pewter • Bronzed  
**Anodic Metals** Twilight • Glow • Sky • Sunrise • Storm • Glimmer • Sunset • Night Sky • Midnight  
**Custom** See page 29 for details  
 Matte @  
 Satin @  
 Gloss @

∅38mm (1 1/2")

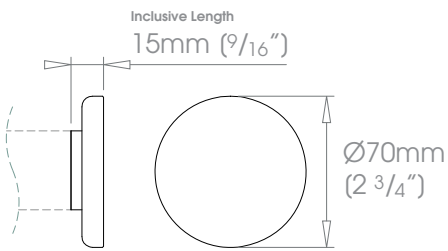



! Can only be added at point of order

**FINISHES** Shades ☉☉☉ Cloud • Alabaster • Bone • Barley • Dusk • Ceramic • Cream • Mineral • Dove • Parchment • Oatmeal • Millstone • Stone • Clay • Grey Moss  
 Slate • Cocoa • Moss • Damson • Smoke • Frame Grey • Lead • Earth • Burnt Ash • Flint • Charcoal • Raven  
 Coat Options **Metallics** ☉☉ Platinum • Champagne • Gold • Cognac • Antique Brass • Gunmetal • Pewter • Bronzed  
**Anodic Metals** Twilight • Glow • Sky • Sunrise • Storm • Glimmer • Sunset • Night Sky • Midnight  
 Matte ☉ **Custom** See page 29 for details  
 Satin ☉  
 Gloss ☉

ø38mm (1 1/2")

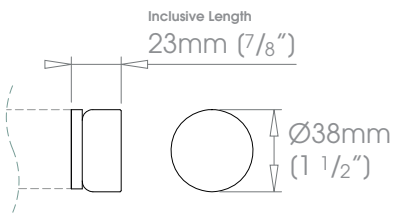



! Can only be added at point of order

**FINISHES** Shades @@@ Cloud • Alabaster • Bone • Barley • Dusk • Ceramic • Cream • Mineral • Dove • Parchment • Oatmeal • Millstone • Stone • Clay • Grey Moss  
 Slate • Cocoa • Moss • Damson • Smoke • Frame Grey • Lead • Earth • Burnt Ash • Flint • Charcoal • Raven  
 Coat Options **Metallics** @@ Platinum • Champagne • Gold • Cognac • Antique Brass • Gunmetal • Pewter • Bronzed  
**Anodic Metals** Twilight • Glow • Sky • Sunrise • Storm • Glimmer • Sunset • Night Sky • Midnight  
 Matte @ **Custom** See page 29 for details  
 Satin @  
 Gloss @

∅38mm (1 1/2")

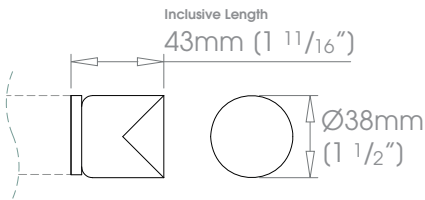





ⓘ Can only be added at point of order  
 Finial detail cannot be used with Flush Ceiling Brackets / Flush Partition Brackets

**FINISHES** Shades @@@ Cloud • Alabaster • Bone • Barley • Dusk • Ceramic • Cream • Mineral • Dove • Parchment • Oatmeal • Millstone • Stone • Clay • Grey Moss  
 Slate • Cocoa • Moss • Damson • Smoke • Frame Grey • Lead • Earth • Burnt Ash • Flint • Charcoal • Raven  
 Coat Options **Metallics** @@ Platinum • Champagne • Gold • Cognac • Antique Brass • Gunmetal • Pewter • Bronzed  
**Anodic Metals** Twilight • Glow • Sky • Sunrise • Storm • Glimmer • Sunset • Night Sky • Midnight  
 Matte @ **Custom** See page 29 for details  
 Satin @  
 Gloss @

ø38mm (1 1/2")

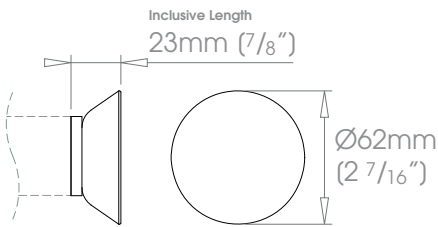



ⓘ Can only be added at point of order  
 Finial detail cannot be used with Flush Ceiling Brackets / Flush Partition Brackets

**FINISHES** Shades @@@ Cloud • Alabaster • Bone • Barley • Dusk • Ceramic • Cream • Mineral • Dove • Parchment • Oatmeal • Millstone • Stone • Clay • Grey Moss  
 Slate • Cocoa • Moss • Damson • Smoke • Frame Grey • Lead • Earth • Burnt Ash • Flint • Charcoal • Raven  
 Coat Options **Metallics** @@ Platinum • Champagne • Gold • Cognac • Antique Brass • Gunmetal • Pewter • Bronzed  
**Anodic Metals** Twilight • Glow • Sky • Sunrise • Storm • Glimmer • Sunset • Night Sky • Midnight  
 Matte @ **Custom** See page 29 for details  
 Satin @  
 Gloss @

∅38mm (1 1/2")

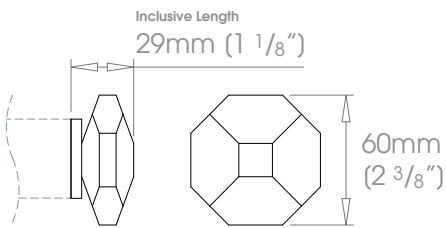



ⓘ Can only be added at point of order  
 Finial detail cannot be used with Flush Ceiling Brackets / Flush Partition Brackets

**FINISHES** Shades @@@ Cloud • Alabaster • Bone • Barley • Dusk • Ceramic • Cream • Mineral • Dove • Parchment • Oatmeal • Millstone • Stone • Clay • Grey Moss  
 Slate • Cocoa • Moss • Damson • Smoke • Frame Grey • Lead • Earth • Burnt Ash • Flint • Charcoal • Raven  
 Coat Options **Metallics** @@ Platinum • Champagne • Gold • Cognac • Antique Brass • Gunmetal • Pewter • Bronzed  
**Anodic Metals** Twilight • Glow • Sky • Sunrise • Storm • Glimmer • Sunset • Night Sky • Midnight  
 Matte @ **Custom** See page 29 for details  
 Satin @  
 Gloss @

∅38mm (1 1/2")

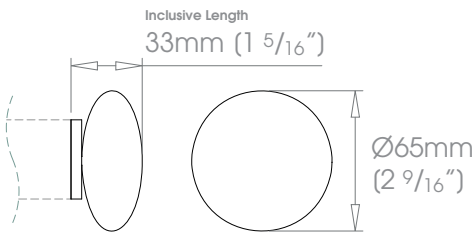





ⓘ Can only be added at point of order  
 Finial detail cannot be used with Flush Ceiling Brackets / Flush Partition Brackets

**FINISHES** Shades @@@ Cloud • Alabaster • Bone • Barley • Dusk • Ceramic • Cream • Mineral • Dove • Parchment • Oatmeal • Millstone • Stone • Clay • Grey Moss  
 Slate • Cocoa • Moss • Damson • Smoke • Frame Grey • Lead • Earth • Burnt Ash • Flint • Charcoal • Raven  
 Coat Options **Metallics** @@ Platinum • Champagne • Gold • Cognac • Antique Brass • Gunmetal • Pewter • Bronzed  
**Anodic Metals** Twilight • Glow • Sky • Sunrise • Storm • Glimmer • Sunset • Night Sky • Midnight  
 Matte @ **Custom** See page 29 for details  
 Satin @  
 Gloss @

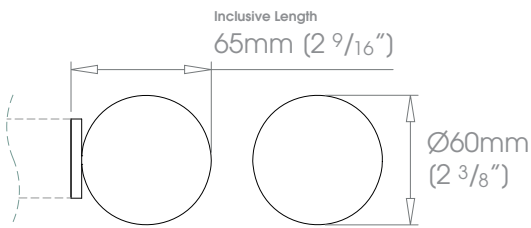
∅38mm (1 1/2")



The following finials from our other collections can be specified on request.

 Finials listed below cannot be used with Flush Ceiling Brackets / Flush Partition Brackets

**MIO**

For specific please refer to the Mio Specification Guide.

Final	Diameter(s)
Stud	∅38mm (1 1/2")
Disc	∅38mm (1 1/2")
Faceted Disc	∅38mm (1 1/2")
Pebble	∅38mm (1 1/2")
Squat Disc	∅38mm (1 1/2")
Ball	∅38mm (1 1/2")
Crystal Ball	∅38mm (1 1/2")

**ELYSIAN**

For specific please refer to the Elysian Specification Guide.

Final	Diameter(s)
Halo	∅38mm (1 1/2")
Aura	∅38mm (1 1/2")
Orbit	∅38mm (1 1/2")
Discus	∅38mm (1 1/2")
Jewel	∅38mm (1 1/2")
Flute	∅38mm (1 1/2")
Squat Globe	∅38mm (1 1/2")
Globe	∅38mm (1 1/2")
Ribbed Globe	∅38mm (1 1/2")
Charm	∅38mm (1 1/2")
Templar	∅38mm (1 1/2")
Crystal Templar	∅38mm (1 1/2")





- FINISHES**
- Shades** ☉☉☉ Cloud • Alabaster • Bone • Barley • Dusk • Ceramic • Cream • Mineral • Dove • Parchment • Oatmeal • Millstone • Stone • Clay • Grey Moss • Slate • Cocoa • Moss • Damson • Smoke • Frame Grey • Lead • Earth • Burnt Ash • Flint • Charcoal • Raven
  - Coat Options**
  - Matte** ☉
  - Satin** ☉
  - Gloss** ☉
  - Metallics** ☉☉ Platinum • Champagne • Gold • Cognac • Antique Brass • Gunmetal • Pewter • Bronzed
  - Anodic Metals** ☉☉ Twilight • Glow • Sky • Sunrise • Storm • Glimmer • Sunset • Night Sky • Midnight
  - Custom** See page 29 for details

ø38mm (1 1/2") - Left Hand Drive

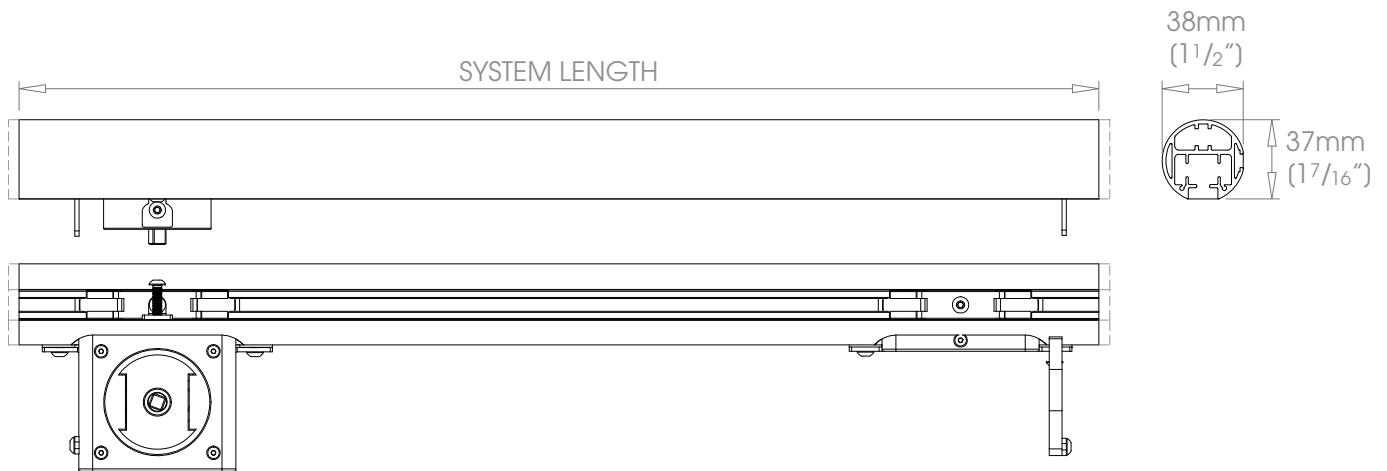

**Glider Options** Single Stack → • Pair Stack →←

- |   |   |  |  |
|---|---|--|--|
| <p><b>GLIDER</b><br/>Colour options<br/>Gypsum • Anthracite</p> | <p><b>SINE GLIDER</b><br/>Colour options<br/>Gypsum • Anthracite</p> <p>Sine Pitch<br/>80mm</p> | <p><b>METALCOAT GLIDER</b><br/>Colour options<br/>System Colour ☉ • Brushed Nickel</p> | <p><b>METALCOAT SINE GLIDER</b><br/>Colour options<br/>System Colour ☉ • Brushed Nickel</p> <p>Sine Pitch<br/>80mm</p> |
|---|---|--|--|

**Roller Options** Single Stack → • Pair Stack →←

- |   |   |  |
|---|---|--|
| <p><b>ROLLER</b><br/>Colour options<br/>White • Black</p> | <p><b>RIPPLEFOLD ROLLER</b><br/>Colour options<br/>White • Black</p> <p>Ripple Pitch<br/>80mm</p> | <p><b>RIPPLEFOLD ROLLER</b><br/>Colour options<br/>White</p> <p>Fullness options<br/>80% • 100% • 120%</p> |
|---|---|--|

⚠ **Roller options not suitable for use on 38mm (1 1/2") bay/curved poles**





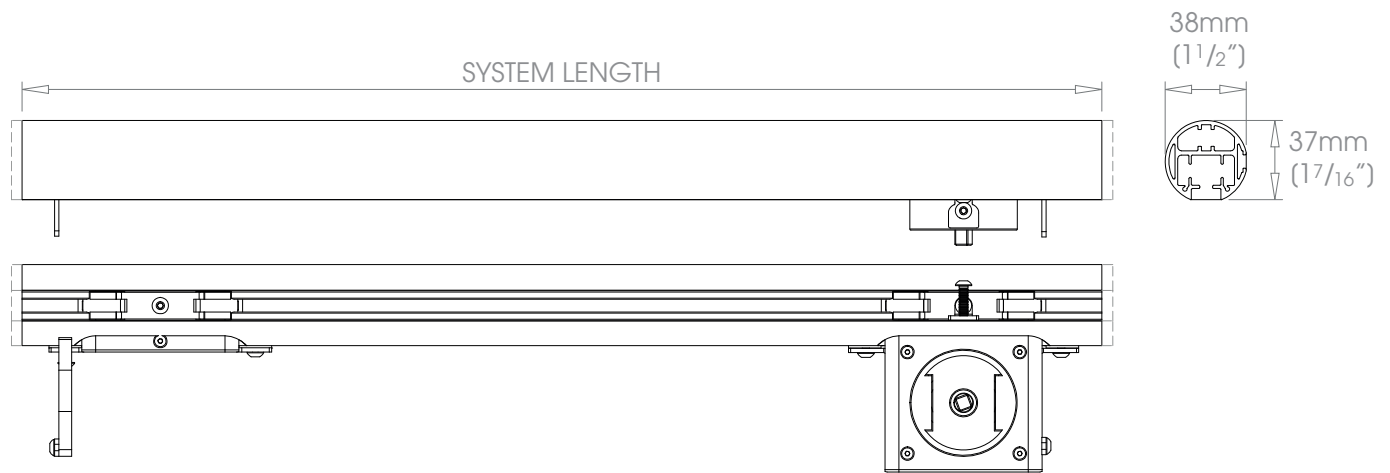

**FINISHES** **Shades** ☉☉☉ Cloud • Alabaster • Bone • Barley • Dusk • Ceramic • Cream • Mineral • Dove • Parchment • Oatmeal • Millstone • Stone • Clay • Grey Moss  
**Coat Options** **Metallics** ☉☉ Platinum • Champagne • Gold • Cognac • Antique Brass • Gunmetal • Pewter • Bronzed  
**Matte** ☉ **Anodic Metals** ☉☉ Twilight • Glow • Sky • Sunrise • Storm • Glimmer • Sunset • Night Sky • Midnight  
**Satin** ☉ **Custom** See page 29 for details  
**Gloss** ☉

ø38mm (1 1/2") - Right Hand Drive



**Glider Options** Single Stack → • Pair Stack → ←

- |  |   |  |  |
|--|---|--|--|
|  <p><b>GLIDER</b><br/>Colour options<br/>Gypsum • Anthracite</p> |  <p><b>SINE GLIDER</b><br/>Colour options<br/>Gypsum • Anthracite</p> <p>Sine Pitch<br/>80mm</p> |  <p><b>METALCOAT GLIDER</b><br/>Colour options<br/>System Colour ☉ • Brushed Nickel</p> |  <p><b>METALCOAT SINE GLIDER</b><br/>Colour options<br/>System Colour ☉ • Brushed Nickel</p> <p>Sine Pitch<br/>80mm</p> |
|--|---|--|--|

**Roller Options** Single Stack → • Pair Stack → ←

- |  |   |  |
|--|---|--|
|  <p><b>ROLLER</b><br/>Colour options<br/>White • Black</p> |  <p><b>RIPPLEFOLD ROLLER</b><br/>Colour options<br/>White • Black</p> <p>Ripple Pitch<br/>80mm</p> |  <p><b>RIPPLEFOLD ROLLER</b><br/>Colour options<br/>White</p> <p>Fullness options<br/>80% • 100% • 120%</p> |
|--|---|--|

! **Roller options not suitable for use on 38mm (1 1/2") bay/curved poles**







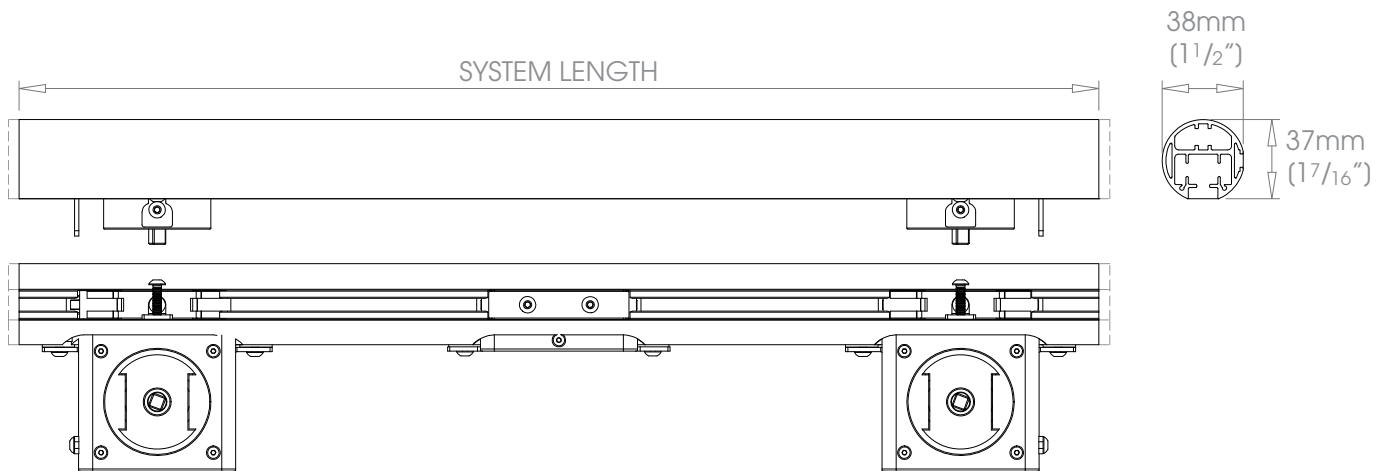

**FINISHES** Shades @@@ Cloud • Alabaster • Bone • Barley • Dusk • Ceramic • Cream • Mineral • Dove • Parchment • Oatmeal • Millstone • Stone • Clay • Grey Moss  
 Slate • Cocoa • Moss • Damson • Smoke • Frame Grey • Lead • Earth • Burnt Ash • Flint • Charcoal • Raven  
 Coat Options  
 Matte @  
 Satin @  
 Gloss @  
 Metallics @@ Platinum • Champagne • Gold • Cognac • Antique Brass • Gunmetal • Pewter • Bronzed  
 Anodic Metals Twilight • Glow • Sky • Sunrise • Storm • Glimmer • Sunset • Night Sky • Midnight  
 Custom See page 29 for details

ø38mm (1 1/2") - Twin Drive



Glider Options Single Stack → • Pair Stack →←

- |  |   |  |  |
|--|---|--|--|
|  <p><b>GLIDER</b><br/>Colour options<br/>Gypsum • Anthracite</p> |  <p><b>SINE GLIDER</b><br/>Colour options<br/>Gypsum • Anthracite</p> <p>Sine Pitch<br/>80mm</p> |  <p><b>METALCOAT GLIDER</b><br/>Colour options<br/>System Colour @ • Brushed Nickel</p> |  <p><b>METALCOAT SINE GLIDER</b><br/>Colour options<br/>System Colour @ • Brushed Nickel</p> <p>Sine Pitch<br/>80mm</p> |
|--|---|--|--|

Roller Options Single Stack → • Pair Stack →←

- |  |   |  |
|--|---|--|
|  <p><b>ROLLER</b><br/>Colour options<br/>White • Black</p> |  <p><b>RIPPLEFOLD ROLLER</b><br/>Colour options<br/>White • Black</p> <p>Ripple Pitch<br/>80mm</p> |  <p><b>RIPPLEFOLD ROLLER</b><br/>Colour options<br/>White</p> <p>Fullness options<br/>80% • 100% • 120%</p> |
|--|---|--|

! Roller options not suitable for use on 38mm (1 1/2") bay/curved poles





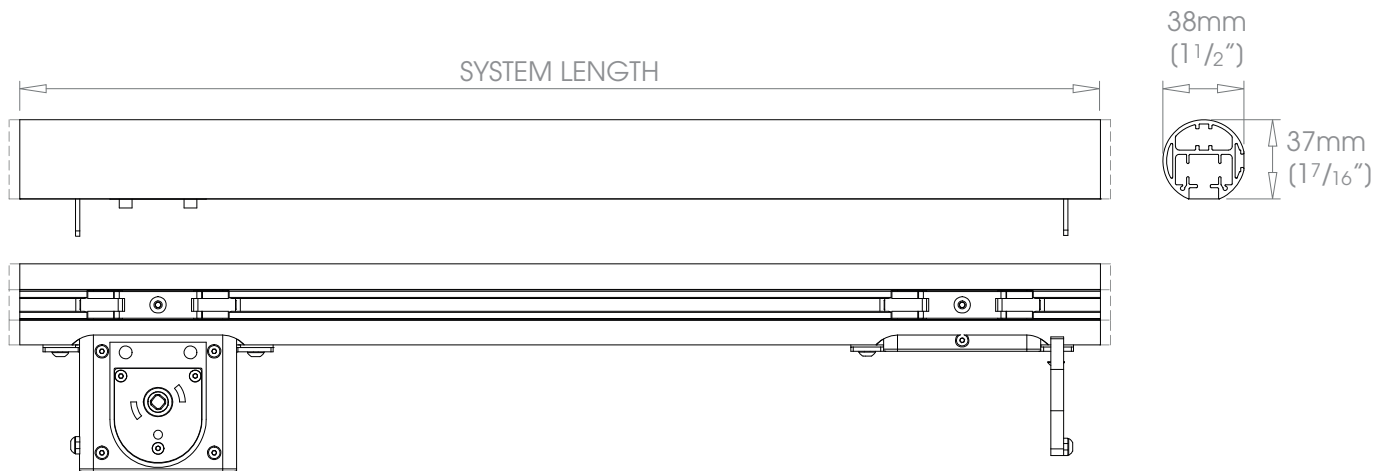

- FINISHES**
- Shades** ☉☉☉ Cloud • Alabaster • Bone • Barley • Dusk • Ceramic • Cream • Mineral • Dove • Parchment • Oatmeal • Millstone • Stone • Clay • Grey Moss • Slate • Cocoa • Moss • Damson • Smoke • Frame Grey • Lead • Earth • Burnt Ash • Flint • Charcoal • Raven
  - Coat Options**
  - Matte** ☉
  - Satin** ☉
  - Gloss** ☉
  - Metallics** ☉☉ Platinum • Champagne • Gold • Cognac • Antique Brass • Gunmetal • Pewter • Bronzed
  - Anodic Metals** ☉☉ Twilight • Glow • Sky • Sunrise • Storm • Glimmer • Sunset • Night Sky • Midnight
  - Custom** See page 29 for details

ø38mm (1 1/2") - Left Hand Drive



**Glider Options** Single Stack → • Pair Stack →←

- |  |   |  |  |
|--|---|--|--|
|  <p><b>GLIDER</b><br/>Colour options<br/>Gypsum • Anthracite</p> |  <p><b>SINE GLIDER</b><br/>Colour options<br/>Gypsum • Anthracite</p> <p>Sine Pitch<br/>80mm</p> |  <p><b>METALCOAT GLIDER</b><br/>Colour options<br/>System Colour ☉ • Brushed Nickel</p> |  <p><b>METALCOAT SINE GLIDER</b><br/>Colour options<br/>System Colour ☉ • Brushed Nickel</p> <p>Sine Pitch<br/>80mm</p> |
|--|---|--|--|

**Roller Options** Single Stack → • Pair Stack →←

- |  |   |  |
|--|---|--|
|  <p><b>ROLLER</b><br/>Colour options<br/>White • Black</p> |  <p><b>RIPPLEFOLD ROLLER</b><br/>Colour options<br/>White • Black</p> <p>Ripple Pitch<br/>80mm</p> |  <p><b>RIPPLEFOLD ROLLER</b><br/>Colour options<br/>White</p> <p>Fullness options<br/>80% • 100% • 120%</p> |
|--|---|--|

! Roller options not suitable for use on 38mm (1 1/2") bay/curved poles





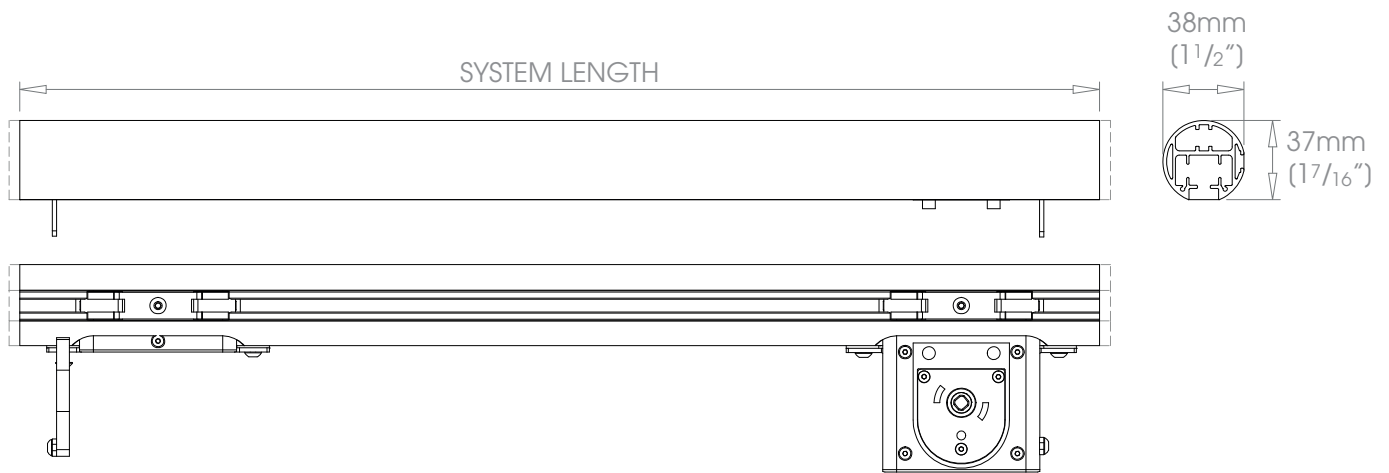

**FINISHES** Shades @@@ Cloud • Alabaster • Bone • Barley • Dusk • Ceramic • Cream • Mineral • Dove • Parchment • Oatmeal • Millstone • Stone • Clay • Grey Moss  
 Slate • Cocoa • Moss • Damson • Smoke • Frame Grey • Lead • Earth • Burnt Ash • Flint • Charcoal • Raven  
 Coat Options  
 Matte @  
 Satin @  
 Gloss @  
**Metallics** @@ Platinum • Champagne • Gold • Cognac • Antique Brass • Gunmetal • Pewter • Bronzed  
**Anodic Metals** Twilight • Glow • Sky • Sunrise • Storm • Glimmer • Sunset • Night Sky • Midnight  
**Custom** See page 29 for details

ø38mm (1 1/2") - Right Hand Drive



**Glider Options** Single Stack → • Pair Stack →←

- |  |  |  |   |
|--|--|--|---|
|  <p><b>GLIDER</b><br/>Colour options<br/>Gypsum • Anthracite</p> |  <p><b>SINE GLIDER</b><br/>Colour options<br/>Gypsum • Anthracite</p> |  <p><b>METALCOAT GLIDER</b><br/>Colour options<br/>System Colour @ • Brushed Nickel</p> |  <p><b>METALCOAT SINE GLIDER</b><br/>Colour options<br/>System Colour @ • Brushed Nickel</p> |
|  | <p>Sine Pitch<br/>80mm</p>   |  | <p>Sine Pitch<br/>80mm</p>  |

**Roller Options** Single Stack → • Pair Stack →←

- |  |  |  |
|--|--|--|
|  <p><b>ROLLER</b><br/>Colour options<br/>White • Black</p> |  <p><b>RIPPLEFOLD ROLLER</b><br/>Colour options<br/>White • Black</p> |  <p><b>RIPPLEFOLD ROLLER</b><br/>Colour options<br/>White</p> |
|  | <p>Ripple Pitch<br/>80mm</p>   | <p>Fullness options<br/>80% • 100% • 120%</p>  |

! Roller options not suitable for use on 38mm (1 1/2") bay/curved poles





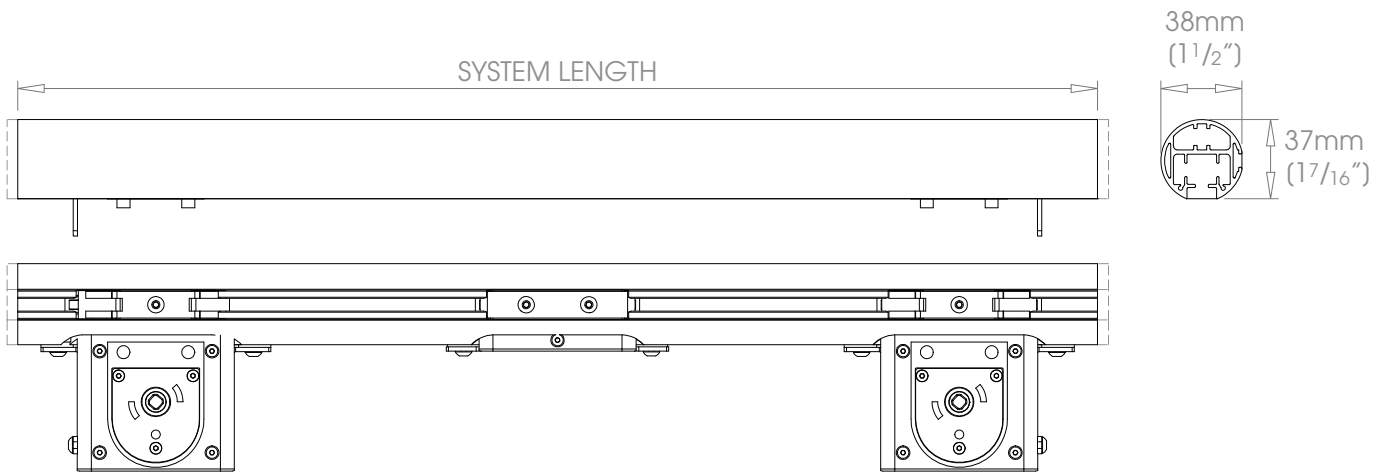

**FINISHES** **Shades** ☉☉☉ Cloud • Alabaster • Bone • Barley • Dusk • Ceramic • Cream • Mineral • Dove • Parchment • Oatmeal • Millstone • Stone • Clay • Grey Moss  
**Coat Options** **Metallics** ☉☉ Platinum • Champagne • Gold • Cognac • Antique Brass • Gunmetal • Pewter • Bronzed  
**Matte** ☉ **Anodic Metals** ☉☉ Twilight • Glow • Sky • Sunrise • Storm • Glimmer • Sunset • Night Sky • Midnight  
**Satin** ☉ **Custom** See page 29 for details  
**Gloss** ☉

ø38mm (1 1/2") - Twin Drive



**Glider Options** Single Stack → • Pair Stack →←

- |  |   |  |  |
|--|---|--|--|
|  <p><b>GLIDER</b><br/>Colour options<br/>Gypsum • Anthracite</p> |  <p><b>SINE GLIDER</b><br/>Colour options<br/>Gypsum • Anthracite</p> <p>Sine Pitch<br/>80mm</p> |  <p><b>METALCOAT GLIDER</b><br/>Colour options<br/>System Colour ☉ • Brushed Nickel</p> |  <p><b>METALCOAT SINE GLIDER</b><br/>Colour options<br/>System Colour ☉ • Brushed Nickel</p> <p>Sine Pitch<br/>80mm</p> |
|--|---|--|--|

**Roller Options** Single Stack → • Pair Stack →←

- |  |   |  |
|--|---|--|
|  <p><b>ROLLER</b><br/>Colour options<br/>White • Black</p> |  <p><b>RIPPLEFOLD ROLLER</b><br/>Colour options<br/>White • Black</p> <p>Ripple Pitch<br/>80mm</p> |  <p><b>RIPPLEFOLD ROLLER</b><br/>Colour options<br/>White</p> <p>Fullness options<br/>80% • 100% • 120%</p> |
|--|---|--|

! **Roller options not suitable for use on 38mm (1 1/2") bay/curved poles**





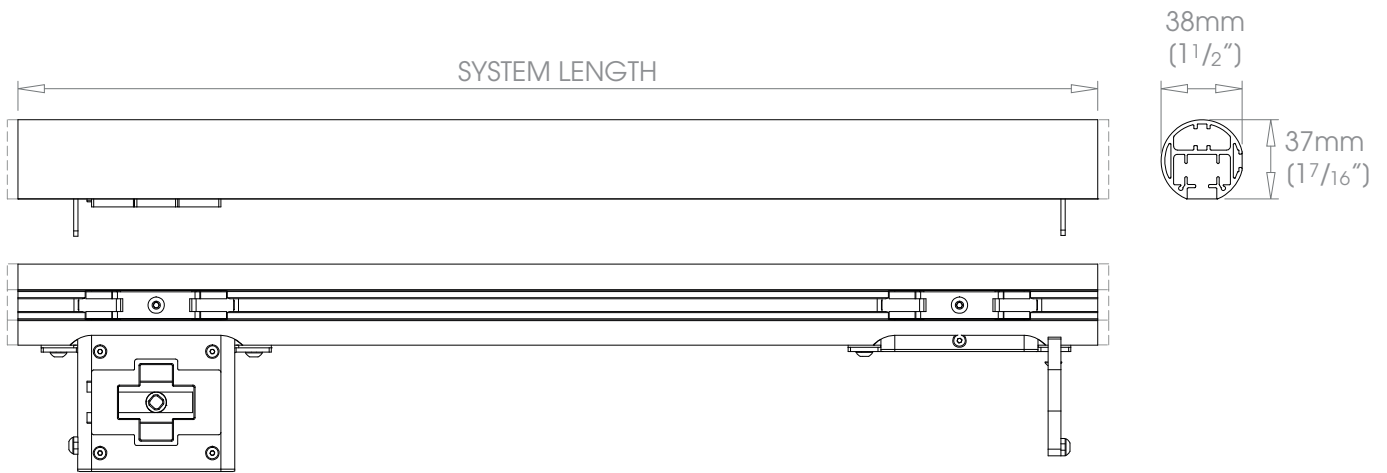

- FINISHES** Shades ☉☉☉ Cloud • Alabaster • Bone • Barley • Dusk • Ceramic • Cream • Mineral • Dove • Parchment • Oatmeal • Millstone • Stone • Clay • Grey Moss  
 Slate • Cocoa • Moss • Damson • Smoke • Frame Grey • Lead • Earth • Burnt Ash • Flint • Charcoal • Raven  
 Coat Options  
 Matte ☉  
 Satin ☉  
 Gloss ☉  
 Metallics ☉☉ Platinum • Champagne • Gold • Cognac • Antique Brass • Gunmetal • Pewter • Bronzed  
 Anodic Metals Twilight • Glow • Sky • Sunrise • Storm • Glimmer • Sunset • Night Sky • Midnight  
 Custom See page 29 for details

ø38mm (1 1/2") - Left Hand Drive



**Glider Options** Single Stack → • Pair Stack →←

- |  |  |  |   |
|--|--|--|---|
| <br><b>GLIDER</b><br>Colour options<br>Gypsum • Anthracite | <br><b>SINE GLIDER</b><br>Colour options<br>Gypsum • Anthracite<br><br>Sine Pitch<br>80mm | <br><b>METALCOAT GLIDER</b><br>Colour options<br>System Colour ☉ • Brushed Nickel | <br><b>METALCOAT SINE GLIDER</b><br>Colour options<br>System Colour ☉ • Brushed Nickel<br><br>Sine Pitch<br>80mm |
|--|--|--|---|

**Roller Options** Single Stack → • Pair Stack →←

- |  |  |   |
|--|--|---|
| <br><b>ROLLER</b><br>Colour options<br>White • Black | <br><b>RIPPLEFOLD ROLLER</b><br>Colour options<br>White • Black<br><br>Ripple Pitch<br>80mm | <br><b>RIPPLEFOLD ROLLER</b><br>Colour options<br>White<br><br>Fullness options<br>80% • 100% • 120% |
|--|--|---|

⚠ **Roller options not suitable for use on 38mm (1 1/2") bay/curved poles**



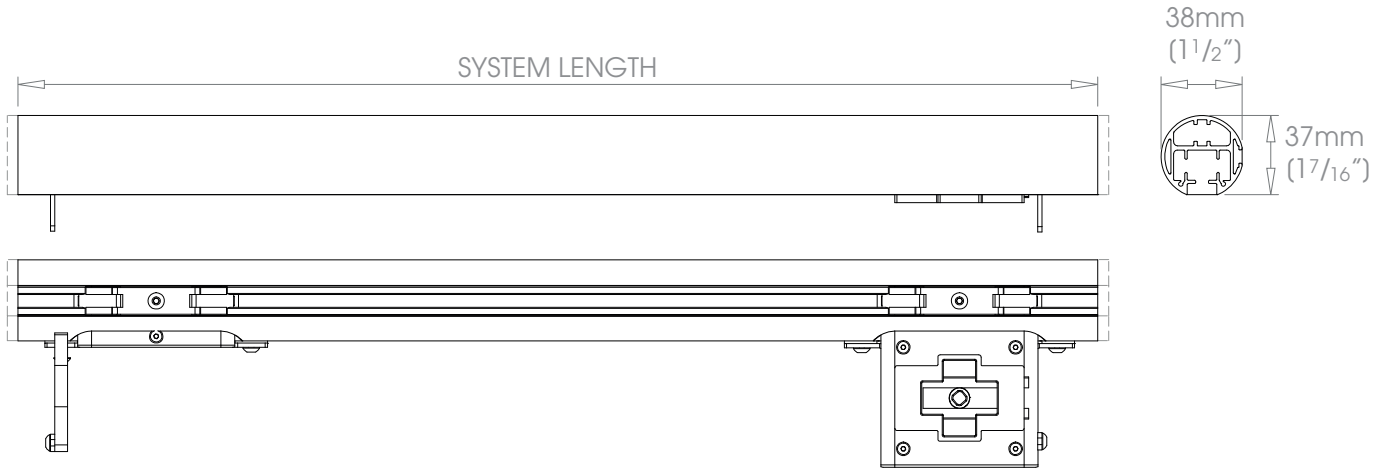

- FINISHES** Shades @@@ Cloud • Alabaster • Bone • Barley • Dusk • Ceramic • Cream • Mineral • Dove • Parchment • Oatmeal • Millstone • Stone • Clay • Grey Moss  
 Slate • Cocoa • Moss • Damson • Smoke • Frame Grey • Lead • Earth • Burnt Ash • Flint • Charcoal • Raven  
 Coat Options **Metallics** @@ Platinum • Champagne • Gold • Cognac • Antique Brass • Gunmetal • Pewter • Bronzed  
**Anodic Metals** Twilight • Glow • Sky • Sunrise • Storm • Glimmer • Sunset • Night Sky • Midnight  
**Custom** See page 29 for details  
 Matte @  
 Satin @  
 Gloss @

ø38mm (1 1/2") - Right Hand Drive



Glider Options Single Stack → • Pair Stack →←

- |  |   |  |  |
|--|---|--|--|
|  <p><b>GLIDER</b><br/>Colour options<br/>Gypsum • Anthracite</p> |  <p><b>SINE GLIDER</b><br/>Colour options<br/>Gypsum • Anthracite</p> <p>Sine Pitch<br/>80mm</p> |  <p><b>METALCOAT GLIDER</b><br/>Colour options<br/>System Colour @ • Brushed Nickel</p> |  <p><b>METALCOAT SINE GLIDER</b><br/>Colour options<br/>System Colour @ • Brushed Nickel</p> <p>Sine Pitch<br/>80mm</p> |
|--|---|--|--|

Roller Options Single Stack → • Pair Stack →←

- |  |   |  |
|--|---|--|
|  <p><b>ROLLER</b><br/>Colour options<br/>White • Black</p> |  <p><b>RIPPLEFOLD ROLLER</b><br/>Colour options<br/>White • Black</p> <p>Ripple Pitch<br/>80mm</p> |  <p><b>RIPPLEFOLD ROLLER</b><br/>Colour options<br/>White</p> <p>Fullness options<br/>80% • 100% • 120%</p> |
|--|---|--|

! Roller options not suitable for use on 38mm (1 1/2") bay/curved poles





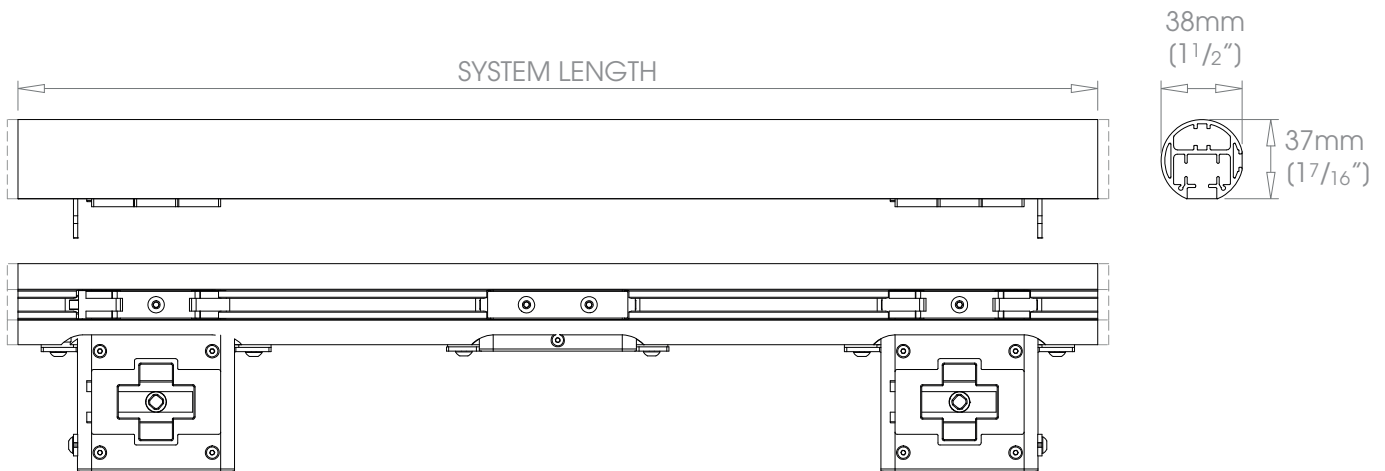

- FINISHES** Shades ☉☉☉ Cloud • Alabaster • Bone • Barley • Dusk • Ceramic • Cream • Mineral • Dove • Parchment • Oatmeal • Millstone • Stone • Clay • Grey Moss  
 Slate • Cocoa • Moss • Damson • Smoke • Frame Grey • Lead • Earth • Burnt Ash • Flint • Charcoal • Raven  
 Coat Options  
 Matte ☉  
 Satin ☉  
 Gloss ☉  
 Metallics ☉☉ Platinum • Champagne • Gold • Cognac • Antique Brass • Gunmetal • Pewter • Bronzed  
 Anodic Metals Twilight • Glow • Sky • Sunrise • Storm • Glimmer • Sunset • Night Sky • Midnight  
 Custom See page 29 for details

ø38mm (1 1/2") - Twin Drive



Glider Options Single Stack → • Pair Stack →←

- |  |   |  |  |
|--|---|--|--|
|  <p><b>GLIDER</b><br/>Colour options<br/>Gypsum • Anthracite</p> |  <p><b>SINE GLIDER</b><br/>Colour options<br/>Gypsum • Anthracite</p> <p>Sine Pitch<br/>80mm</p> |  <p><b>METALCOAT GLIDER</b><br/>Colour options<br/>System Colour ☉ • Brushed Nickel</p> |  <p><b>METALCOAT SINE GLIDER</b><br/>Colour options<br/>System Colour ☉ • Brushed Nickel</p> <p>Sine Pitch<br/>80mm</p> |
|--|---|--|--|

Roller Options Single Stack → • Pair Stack →←

- |  |   |  |
|--|---|--|
|  <p><b>ROLLER</b><br/>Colour options<br/>White • Black</p> |  <p><b>RIPPLEFOLD ROLLER</b><br/>Colour options<br/>White • Black</p> <p>Ripple Pitch<br/>80mm</p> |  <p><b>RIPPLEFOLD ROLLER</b><br/>Colour options<br/>White</p> <p>Fullness options<br/>80% • 100% • 120%</p> |
|--|---|--|

⚠ Roller options not suitable for use on 38mm (1 1/2") bay/curved poles



! Return bends are not available.

**FINISHES** Shades @@@ Cloud • Alabaster • Bone • Barley • Dusk • Ceramic • Cream • Mineral • Dove • Parchment • Oatmeal • Millstone • Stone • Clay • Grey Moss  
 Slate • Cocoa • Moss • Damson • Smoke • Frame Grey • Lead • Earth • Burnt Ash • Flint • Charcoal • Raven  
 Coat Options **Metallics** @@ Platinum • Champagne • Gold • Cognac • Antique Brass • Gunmetal • Pewter • Bronzed  
**Anodic Metals** Twilight • Glow • Sky • Sunrise • Storm • Glimmer • Sunset • Night Sky • Midnight  
 Matte @ **Custom** See page 29 for details  
 Satin @  
 Gloss @

ø38mm (1 1/2")

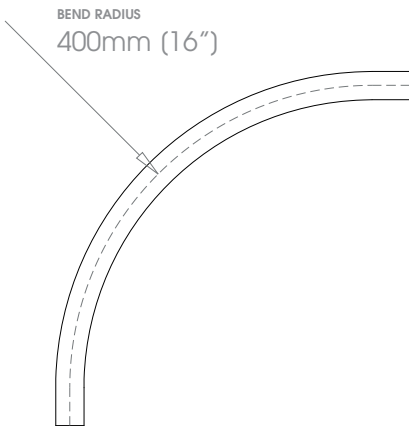

! Roller options not suitable for use on 38mm (1 1/2") bay poles





**FINISHES** Shades @@@ Cloud • Alabaster • Bone • Barley • Dusk • Ceramic • Cream • Mineral • Dove • Parchment • Oatmeal • Millstone • Stone • Clay • Grey Moss  
 Slate • Cocoa • Moss • Damson • Smoke • Frame Grey • Lead • Earth • Burnt Ash • Flint • Charcoal • Raven  
 Coat Options **Metallics** @@ Platinum • Champagne • Gold • Cognac • Antique Brass • Gunmetal • Pewter • Bronzed  
**Anodic Metals** Twilight • Glow • Sky • Sunrise • Storm • Glimmer • Sunset • Night Sky • Midnight  
 Matte @ **Custom** See page 29 for details  
 Satin @  
 Gloss @

ø38mm (1 1/2")

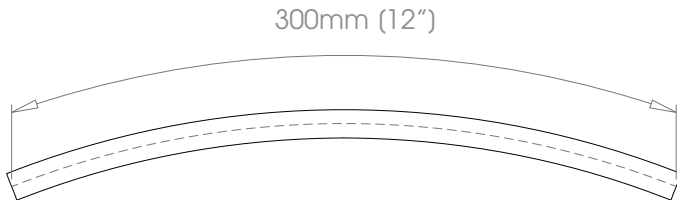

⚠ Roller options not suitable for use on 38mm (1 1/2") curved poles



! Motor and Return Cartridges can be positioned at the mitre. Highlighted grey area is a non running space.

- FINISHES** Shades @@@ Cloud • Alabaster • Bone • Barley • Dusk • Ceramic • Cream • Mineral • Dove • Parchment • Oatmeal • Millstone • Stone • Clay • Grey Moss  
 Slate • Cocoa • Moss • Damson • Smoke • Frame Grey • Lead • Earth • Burnt Ash • Flint • Charcoal • Raven  
 Coat Options **Metallics** @@ Platinum • Champagne • Gold • Cognac • Antique Brass • Gunmetal • Pewter • Bronzed  
**Anodic Metals** Twilight • Glow • Sky • Sunrise • Storm • Glimmer • Sunset • Night Sky • Midnight  
**Custom** See page 29 for details  
 Matte @  
 Satin @  
 Gloss @

ø38mm (1 1/2") - Motor Cartridges

ø38mm (1 1/2") - Return Cartridges

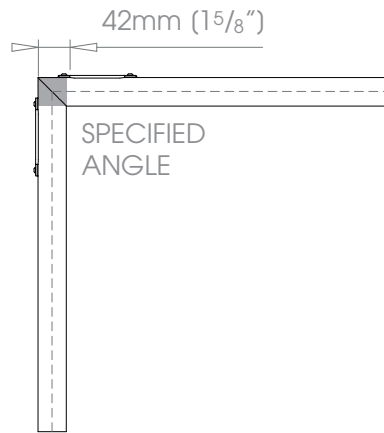
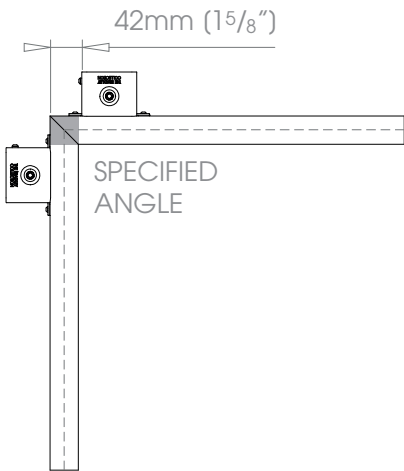





 Customised brackets available - See page 9

**FINISHES** Shades @@@ Cloud • Alabaster • Bone • Barley • Dusk • Ceramic • Cream • Mineral • Dove • Parchment • Oatmeal • Millstone • Stone • Clay • Grey Moss  
 Slate • Cocoa • Moss • Damson • Smoke • Frame Grey • Lead • Earth • Burnt Ash • Flint • Charcoal • Raven  
 Coat Options **Metallics** @@ Platinum • Champagne • Gold • Cognac • Antique Brass • Gunmetal • Pewter • Bronzed  
**Anodic Metals** Twilight • Glow • Sky • Sunrise • Storm • Glimmer • Sunset • Night Sky • Midnight  
 Matte @ **Custom** See page 29 for details  
 Satin @  
 Gloss @

∅38mm (1 1/2")

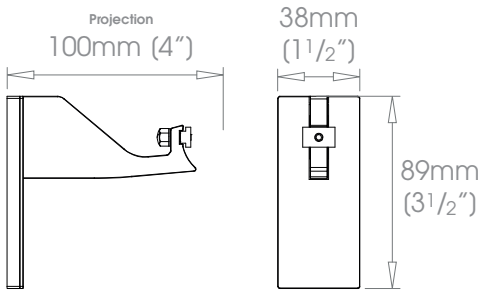



 Customised brackets available - See page 9

**FINISHES** **Shades** @@@ Cloud • Alabaster • Bone • Barley • Dusk • Ceramic • Cream • Mineral • Dove • Parchment • Oatmeal • Millstone • Stone • Clay • Grey Moss  
**Coat Options** **Metallics** @@ Platinum • Champagne • Gold • Cognac • Antique Brass • Gunmetal • Pewter • Bronzed  
**Anodic Metals** Twilight • Glow • Sky • Sunrise • Storm • Glimmer • Sunset • Night Sky • Midnight  
**Custom** See page 29 for details  
 Matte @  
 Satin @  
 Gloss @

ø38mm (1 1/2")

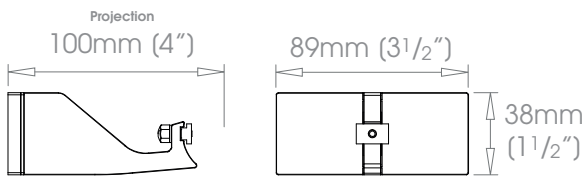



 Customised brackets available - See page 9

**FINISHES** **Shades** @@@ Cloud • Alabaster • Bone • Barley • Dusk • Ceramic • Cream • Mineral • Dove • Parchment • Oatmeal • Millstone • Stone • Clay • Grey Moss  
**Coat Options** **Metallics** @@ Slate • Cocoa • Moss • Damson • Smoke • Frame Grey • Lead • Earth • Burnt Ash • Flint • Charcoal • Raven  
**Matte** @ **Anodic Metals** @ Platinum • Champagne • Gold • Cognac • Antique Brass • Gunmetal • Pewter • Bronzed  
**Satin** @ **Custom** Twilight • Glow • Sky • Sunrise • Storm • Glimmer • Sunset • Night Sky • Midnight  
**Gloss** @ See page 29 for details

ø38mm (1 1/2")

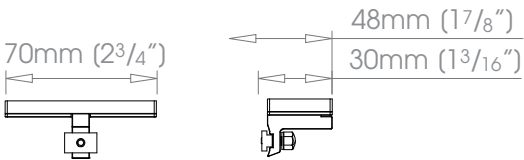

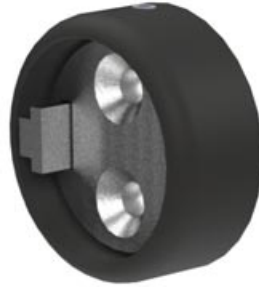

ⓘ Recess brackets are not suitable for use with flush ceiling brackets

**FINISHES** Shades ☉☉☉ Cloud • Alabaster • Bone • Barley • Dusk • Ceramic • Cream • Mineral • Dove • Parchment • Oatmeal • Millstone • Stone • Clay • Grey Moss  
 Slate • Cocoa • Moss • Damson • Smoke • Frame Grey • Lead • Earth • Burnt Ash • Flint • Charcoal • Raven  
 Coat Options **Metallics** ☉☉ Platinum • Champagne • Gold • Cognac • Antique Brass • Gunmetal • Pewter • Bronzed  
**Anodic Metals** Twilight • Glow • Sky • Sunrise • Storm • Glimmer • Sunset • Night Sky • Midnight  
 Matte ☉ **Custom** See page 29 for details  
 Satin ☉  
 Gloss ☉

∅38mm (1 1/2")

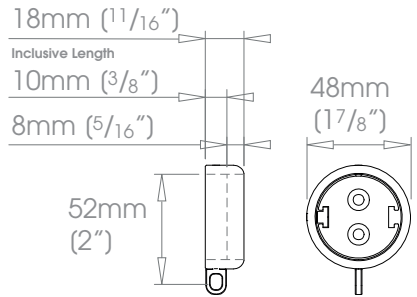

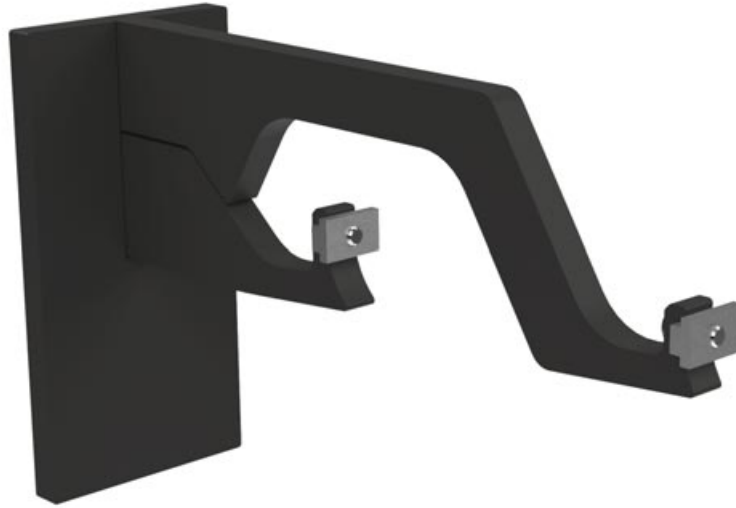

**FINISHES** **Shades** ☉☉☉☉ Cloud • Alabaster • Bone • Barley • Dusk • Ceramic • Cream • Mineral • Dove • Parchment • Oatmeal • Millstone • Stone • Clay • Grey Moss  
 Slate • Cocoa • Moss • Damson • Smoke • Frame Grey • Lead • Earth • Burnt Ash • Flint • Charcoal • Raven  
**Coat Options** **Metallics** ☉☉ Platinum • Champagne • Gold • Cognac • Antique Brass • Gunmetal • Pewter • Bronzed  
**Anodic Metals** Twilight • Glow • Sky • Sunrise • Storm • Glimmer • Sunset • Night Sky • Midnight  
**Matte** ☉ **Custom** See page 29 for details  
**Satin** ☉  
**Gloss** ☉

F38mm (1 1/2") B38mm (1 1/2")

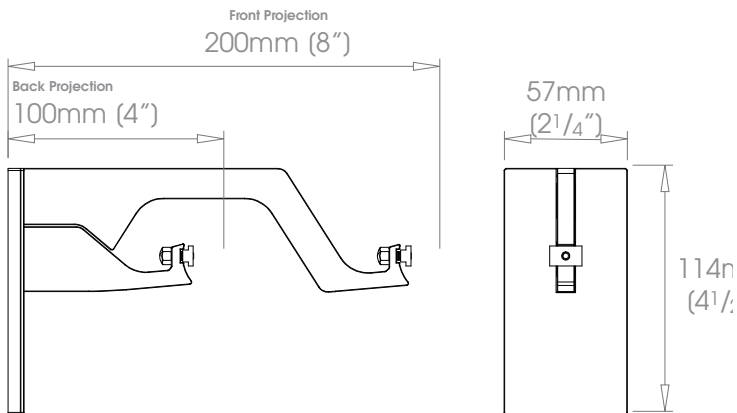





**FINISHES** Shades ☉☉☉ Cloud • Alabaster • Bone • Barley • Dusk • Ceramic • Cream • Mineral • Dove • Parchment • Oatmeal • Millstone • Stone • Clay • Grey Moss  
 Slate • Cocoa • Moss • Damson • Smoke • Frame Grey • Lead • Earth • Burnt Ash • Flint • Charcoal • Raven  
 Coat Options **Metallics** ☉☉ Platinum • Champagne • Gold • Cognac • Antique Brass • Gunmetal • Pewter • Bronzed  
**Anodic Metals** Twilight • Glow • Sky • Sunrise • Storm • Glimmer • Sunset • Night Sky • Midnight  
 Matte ☉ **Custom** See page 29 for details  
 Satin ☉  
 Gloss ☉

F38mm (1 1/2") B38mm (1 1/2")

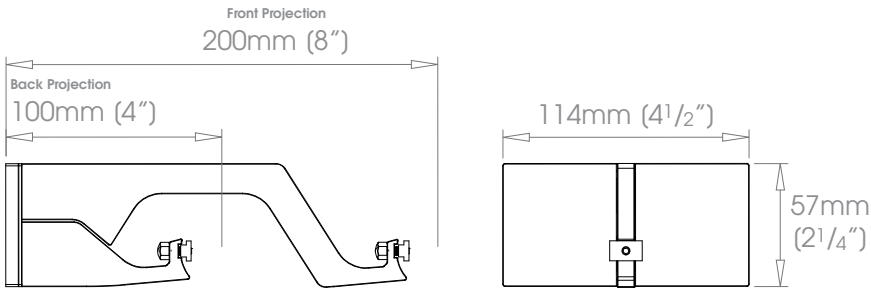



**FINISHES** Shades @@@ Cloud • Alabaster • Bone • Barley • Dusk • Ceramic • Cream • Mineral • Dove • Parchment • Oatmeal • Millstone • Stone • Clay • Grey Moss  
 Slate • Cocoa • Moss • Damson • Smoke • Frame Grey • Lead • Earth • Burnt Ash • Flint • Charcoal • Raven  
 Coat Options **Metallics** @@ Platinum • Champagne • Gold • Cognac • Antique Brass • Gunmetal • Pewter • Bronzed  
**Anodic Metals** Twilight • Glow • Sky • Sunrise • Storm • Glimmer • Sunset • Night Sky • Midnight  
**Custom** See page 29 for details  
 Matte @  
 Satin @  
 Gloss @

F38mm (1 1/2") B38mm (1 1/2")

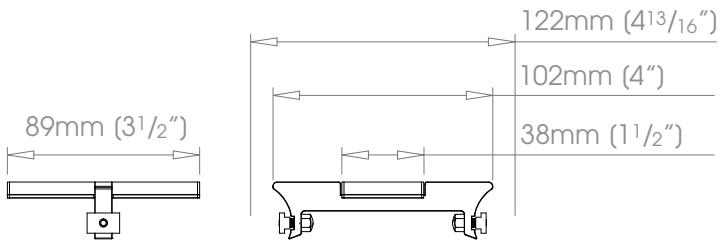

# CONTACT

[www.bradleycollection.com](http://www.bradleycollection.com)



## UK & REST OF THE WORLD

+44 (0)1449 722 724  
[info@bradleycollection.com](mailto:info@bradleycollection.com)

## USA & CANADA

+1 (310) 815 8255  
[info.us@bradleycollection.com](mailto:info.us@bradleycollection.com)

---

## LONDON SHOWROOM

+44 (0)207 871 7793  
[showroom@studiotwochelsea.com](mailto:showroom@studiotwochelsea.com)

## THE BRADLEY COLLECTION



**Industry Partner**  
Supporting the interior design profession

CEDIA  
MEMBER

Specialised fixings for mounting brackets will be required in certain situations and are not provided as standard. Steel items are not recommended for damp conditions such as shower rooms. Crystal finials should not be positioned in direct sunlight, and are not suitable for use in conservatories. Fluid Metal items are supplied unlacquered and will tarnish over time.

The Bradley Collection reserves the right to modify design and materials without prior notice as part of a process of continual product improvement. Due to printing limitations, colours in this brochure may not be accurate.

Products are protected by Design Rights, under provisions of Copyright, Designs & Patents Act 1988. Bradley®, The Bradley Collection® and  Logo are registered Community trademarks of The Bradley Collection Ltd. in Europe and registered trademarks of the Bradley Collection, Inc. in the USA.

**The Bradley Collection Ltd** Lion Barn • Maitland Road • Needham Market • Suffolk • IP6 8NS • UK