

⚡ | DRIVE

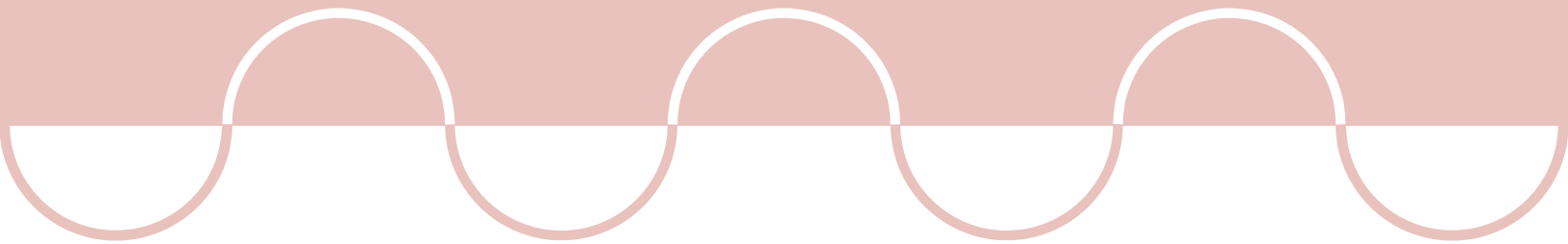

THE **BRADLEY**  
COLLECTION

CURTAIN MAKEUP GUIDE  
SINE GLIDERS • RIPPLE ROLLERS

# CURTAIN MAKEUP GUIDE

## SINE GLIDERS • RIPPLE ROLLERS

Many workrooms will have their own method of manufacturing wave-shaped curtains. This guide is intended to give you a suggested make up method.

When using your own fabrics we suggest that sample curtains are made to determine whether, it is suitable to create wave-shaped curtains.

In general, stiffer fabrics tend not to lend themselves to the wave-shape since they struggle to hold the soft curves for the drop of the curtain.

Once you have confirmed your fabric is suitable, you may want to consider using lead weight tape and curtain side weights for an improved finished appearance.

The maximum weight that the pocketed heading tape can carry with gliders is 2.5kg per metre of track. With roller cord has much higher weight limitations. However, individual track weight restrictions still apply.

**Fabric** Page 2

**Essential Parts** Page 3

**Glider & Roller Spacing** Page 4

**Header Tape** Page 5

**Making Wave-Shaped Curtains** Page 6

**Hook Placement** Page 7

**Dressing the Curtains** Page 8

There is no standard test that will indicate whether a fabric is suitable for wave-shaped curtains. However, experience suggests it is normally suitable for

✓ Voiles • Lined cotton • Interlined Silk • Blackout lining

The soft curves do not lend themselves to:

✗ Stiff fabrics • Heavy embroidery • Irregular vertical stripes • Metallic threads

We recommend a simple test to indicate whether fabric will be suitable (see image right). Hold the top of the fabric in this way and see if the curtain follows a soft wave-shaped pattern without too much effort.

Wave-shaped curtains will require some dressing and training. The extent of this will depend on the flexibility of the weave of the fabric chosen.

✓ SUITABLE FABRIC

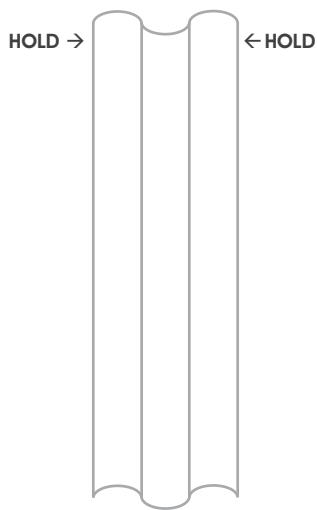

✗ UNSUITABLE FABRIC

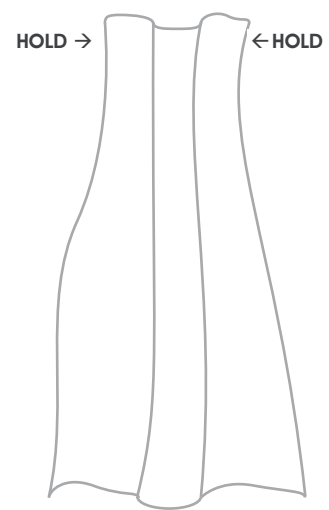

**SINE GLIDERS**

Gliders are suitable for most installations.

**Sine Pitch:** 80mm (3 1/8")

**Colour Options:** Gypsum • Anthracite

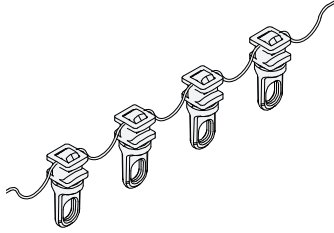

**METALCOAT SINE GLIDERS**

Gliders are suitable for most installations.

**Sine Pitch:** 80mm (3 1/8")

**Colour Options:** System Colour © • Brushed Nickel

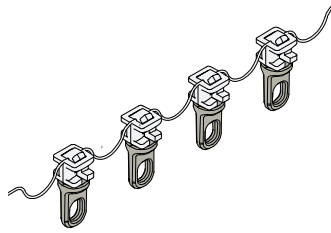

**RIPPLE ROLLERS**

Rollers are preferred for heavy drapery.

**Ripple Pitch:** 80mm (3 1/8")

**Ripple Roller Colour Options:** White • Black

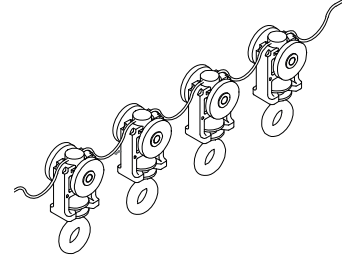

**POCKETED HEADING TAPE**

Various heading tapes are available to produce wave-shaped curtains, Double row tape can be supplied on request.

**Colour Options:** White • Black

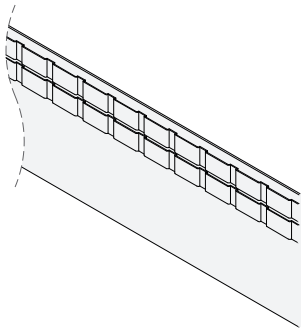

DOUBLE ROW

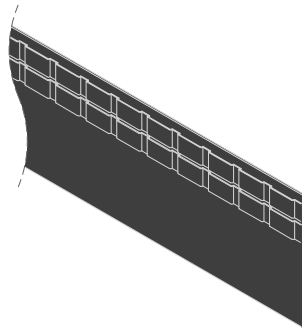

SINGLE ROW

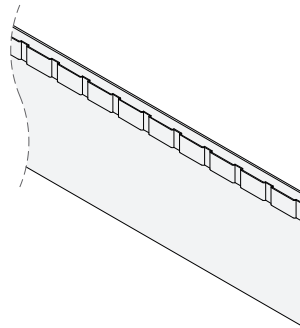

TOP & BOTTOM ROW

**CURTAIN HOOKS**

**Colour Options:** White • Black

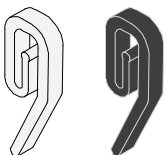

**IRON ON TAPE**

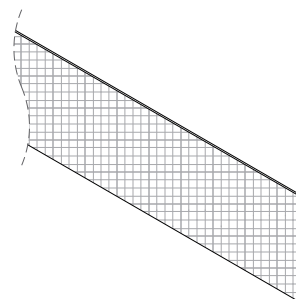

**CURTAIN WEIGHT CORD**

(Optional)

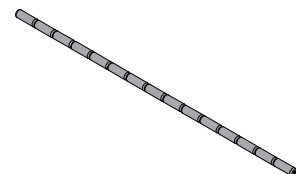



The curtain fullness indicated below and throughout this guide applies to finished curtain fabric. You will need to allow additional fabric for joins, hems and your usual workroom allowances.

### SINE GLIDERS

**Sine Pitch:** 80mm (3 1/8")

**Colour Options:** Gypsum • Anthracite

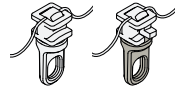

Glider Spacing	Curtain Hook Spacing	Pocket Spacing	Approx. Curtain Fullness	Stack Width per 1M (39 3/8") of pole	Stack Depth Front to Back	Min Bracket Projection
80mm (3 1/8")	160mm (6 5/16")	7	2.3	180mm (7 1/16")	160mm (6 5/16")	100mm (4")

### RIPPLE ROLLERS

**Ripple Pitch:** 80mm (3 1/8")

**Ripple Roller Colour Options:** White • Black



Roller Spacing	Curtain Hook Spacing	Pocket Spacing	Approx. Curtain Fullness	Stack Width per 1M (39 3/8") of pole	Stack Depth Front to Back	Min Bracket Projection
80mm (3 1/8")	160mm (6 5/16")	7	2.3	180mm (7 1/16")	160mm (6 5/16")	100mm (4")

### POCKET SPACING

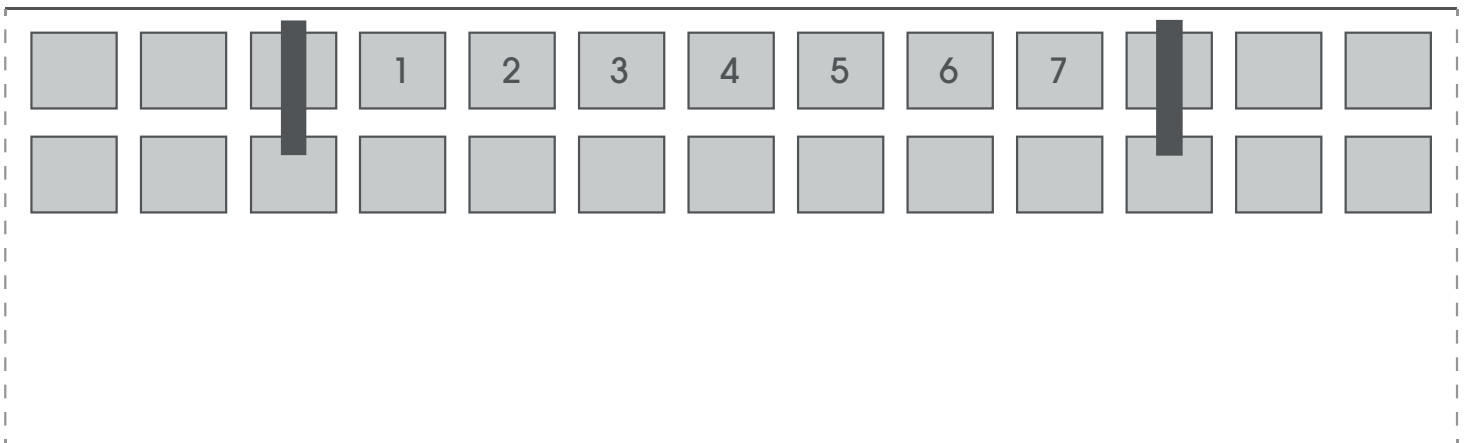

## CALCULATE THE LENGTH OF THE HEADER TAPE

Check your order paperwork, the number of Sine Gliders/Ripple Rollers the system should be listed.

If you can not find this information please call to sales desk, who will be happy to help.

Alternatively use the number of gliders calculated from the previous stage to determine the length of your heading tape.

Do not cut your fabric until you have confirmed the length of the heading tape

To calculate how much heading tape you require, visit [www.bradleycollection.com/downloads/](http://www.bradleycollection.com/downloads/) and download the Drive Sine/Ripple Calculator. This tool automatically calculates the heading tape required.

- 1 Select Drive
- 2 Select single or pair stack
- 3 Pick motor type
- 4 Input the pole length
- 5 See calculated Hooking Points and Pocket total

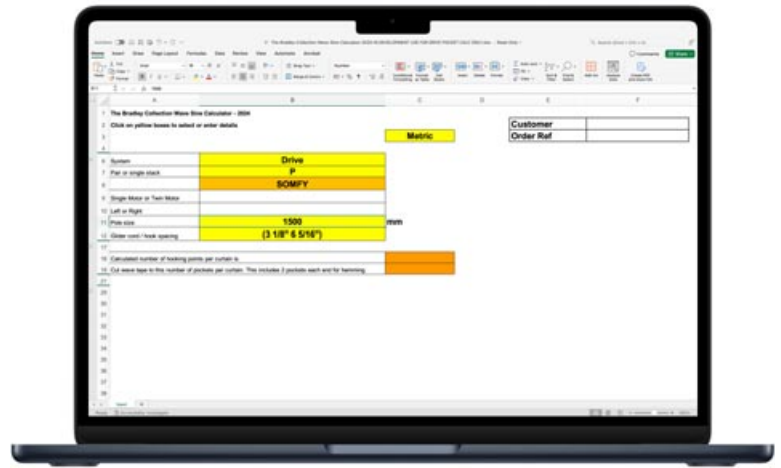

Pockets should be counted Not measured  
Do not cut your fabric yet!

- 1 Cut the pocket tape according to the number of pockets.  
The pocketed tape has a small stitch mark every 50 pockets to help count out the correct length of tape.

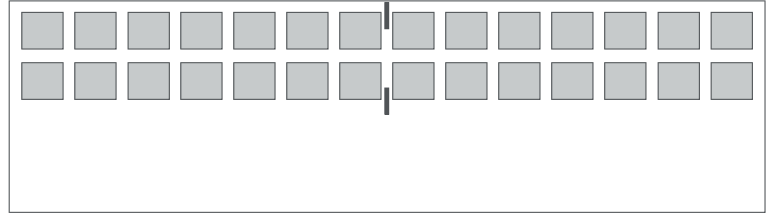

- 2 Turn in 2 pockets at each end of the tape.  
Now you have your finished curtain width, measure this to cut your fabric.

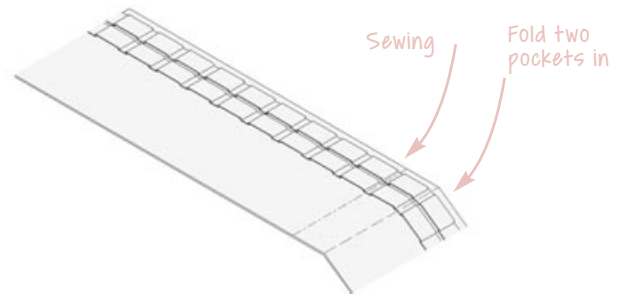

- 3 We recommend that you use an iron tape to avoid fabric puckering and give a professional finish to the top hem.

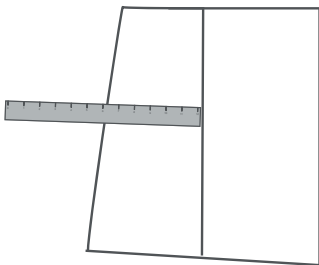

- 1 Measure the hem to 87mm (3<sup>7</sup>/<sub>16</sub>"

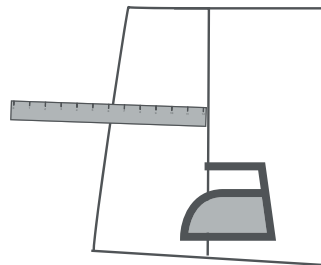

- 2 Iron the into position.

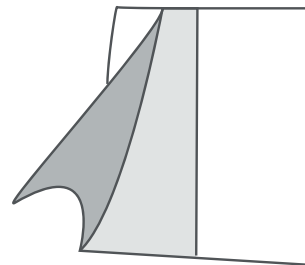

- 3 Lift the hem back and lay on the iron-on tape

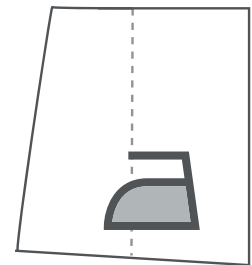

- 4 Iron the hem so that the tape melts. Ensure the two parts are stuck together

- 4 The tape can now be sewn to the top of the curtain.  
This needs to be set 12mm (1/2") from the top of the curtain.  
This has been calculated to give the correct hook drop when sewn in position.

**HEADER  
TAPE  
POSITION**

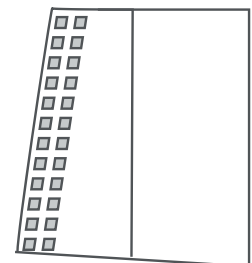

5 Insert the hooks based on the diagrams below.

**!** Standard Pocket Spacing is 7. Leave 7 empty pockets between hooks  
If pocketed tape has 2 sets of pockets use the top set of pockets

**A MOTOR & RETURN EDGE**

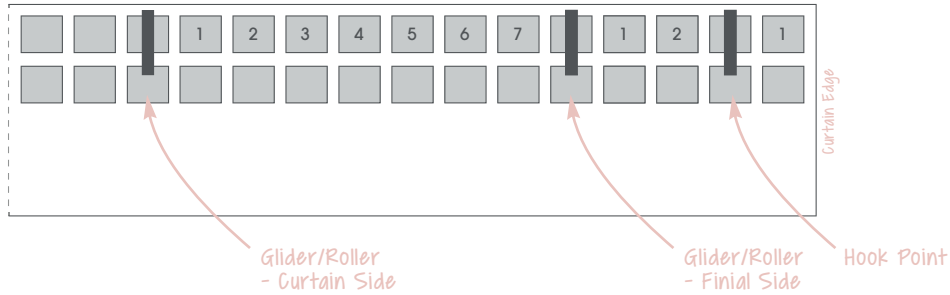

**B STANDARD SPACING BETWEEN CURTAIN EDGES**

Leave 7 empty pockets between hooks

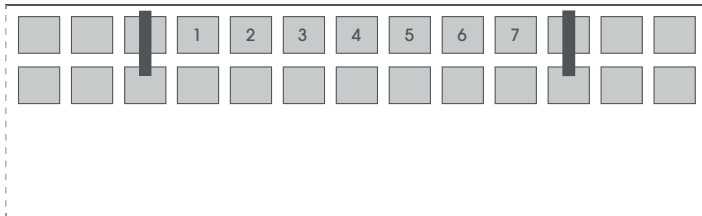

**C LEADING CURTAIN EDGE**

SINGLE DRIVE - SINGLE STACK → • TWIN DRIVE - PAIR STACK → ←

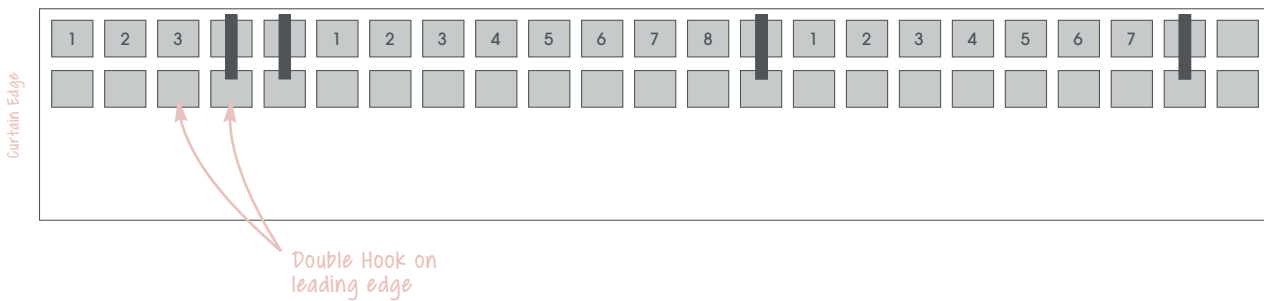

SINGLE DRIVE - PAIR STACK → → ←

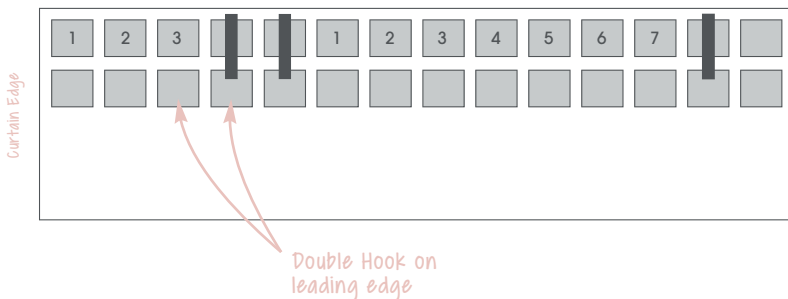



- 6 When hanging the curtain pull the first fold towards you and the second away from you.

**CURTAIN DRESSED CORRECTLY**

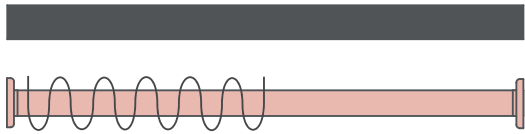

**CURTAIN DRESSED INCORRECTLY**

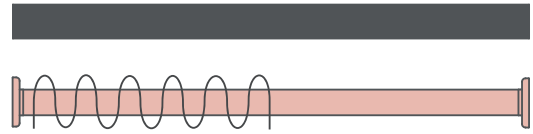

- 
- 7 If the fabric does not automatically fall into the wave-shape at the bottom we recommend you try using a lead weight cord in the hem and fabric side weights.

# CONTACT

[www.bradleycollection.com](http://www.bradleycollection.com)



## UK & REST OF THE WORLD

+44 (0)1449 722 724

[info@bradleycollection.com](mailto:info@bradleycollection.com)

## USA & CANADA

+1 (310) 815 8255

[info.us@bradleycollection.com](mailto:info.us@bradleycollection.com)

---

## LONDON SHOWROOM

+44 (0)207 871 7793

[showroom@studiotwochelsea.com](mailto:showroom@studiotwochelsea.com)

## THE BRADLEY COLLECTION



**Industry Partner**

Supporting the interior design profession

CEDIA  
MEMBER

Specialised fixings for mounting brackets will be required in certain situations and are not provided as standard. Steel items are not recommended for damp conditions such as shower rooms. Crystal finials should not be positioned in direct sunlight, and are not suitable for use in conservatories. Fluid Metal items are supplied unlacquered and will tarnish over time.

The Bradley Collection reserves the right to modify design and materials without prior notice as part of a process of continual product improvement. Due to printing limitations, colours in this brochure may not be accurate.

Products are protected by Design Rights, under provisions of Copyright, Designs & Patents Act 1988. Bradley®, The Bradley Collection® and  Logo are registered Community trademarks of The Bradley Collection Ltd. in Europe and registered trademarks of the Bradley Collection, Inc. in the USA.

**The Bradley Collection Ltd** Lion Barn • Maitland Road • Needham Market • Suffolk • IP6 8NS • UK