

GLIDERPOLE[®]

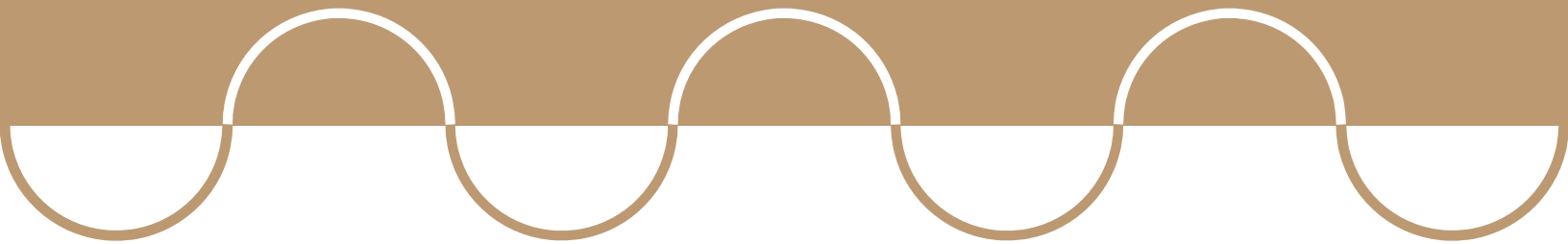

THE **BRADLEY**
COLLECTION



WAVE CURTAIN MAKEUP GUIDE

WAVE CURTAIN MAKEUP GUIDE

Many workrooms will have their own method of manufacturing Wave curtains. This guide is intended to give you a suggested make up method so you get the best from the Silent Gliss Wave system.

When using your own fabrics we suggest that sample curtains are made to determine whether;

- A It is suitable for use with Wave,
- B If so, which size of Wave is most appropriate.

In general, stiffer fabrics tend not to lend themselves to Wave since they struggle to hold the soft curves. For the drop of the curtain.

Once you have confirmed your fabric is suitable for Wave you may want to consider using lead weight tape and curtain side weights for an improved finished appearance.

The maximum weight that the Wave heading tape can carry with glider cord is 2.5kg per metre of track. Wave with roller cord has much higher weight limitations. However, individual track weight restrictions still apply. (for corded systems please refer to the relevant specification guide.)

This guide is based on using the recommended Wave component parts.

Introduction Page 2

Fabrics Page 3

Essential Parts Page 4

Glider & Roller Spacing Page 5-6

Glider & Roller Calculator Page 7-8

Header Tape Page 9

Making Wave Curtains Page 10-11

Wave curtains will work with one of the following Gliderpole® options

HAND DRAWN



CORDED



There is no standard test that will indicate whether a fabric is suitable for Wave. However, experience suggests it is normally suitable for

✓ Voiles • Lined cotton • Interlined Silk • Blackout lining

The soft curves of Wave do not lend themselves to:

✗ Stiff fabrics • Heavy embroidery • Irregular vertical stripes • Metallic threads

We recommend a simple test to indicate whether Wave will be suitable (see image right). Hold the top of the fabric in this way and see if the curtain follows a soft wave pattern without too much effort. Even Wave curtains will require some dressing and training. The extent of this will depend on the flexibility of the weave of the fabric chosen.

✓ SUITABLE FABRIC

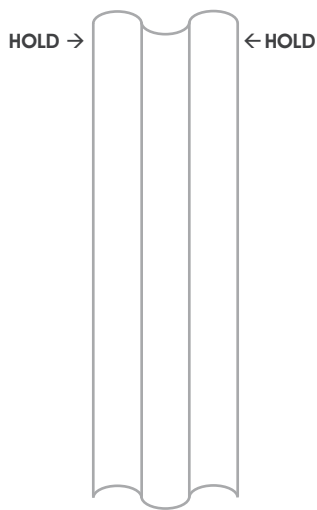

✗ UNSUITABLE FABRIC

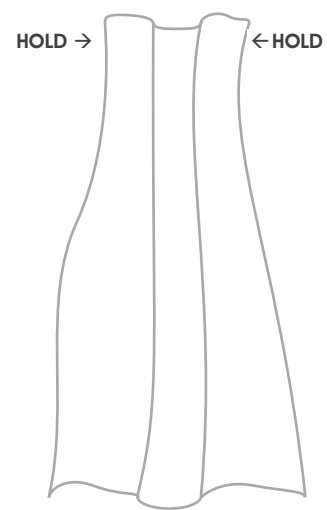

WAVE GLIDERS

Gliders are suitable for most installations.

Wave Pitch: 80mm (3 1/8") (Standard) • 60mm (2 3/8")

Colour Options: White • Black

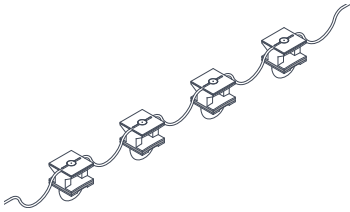

WAVE ROLLERS

Gliders are suitable for most installations.

Wave Pitch: 80mm (3 1/8") (Standard) **Colour**

Options: White

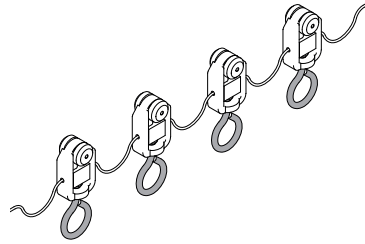

WAVE POCKETED HEADING TAPE

Colour Options: White • Black

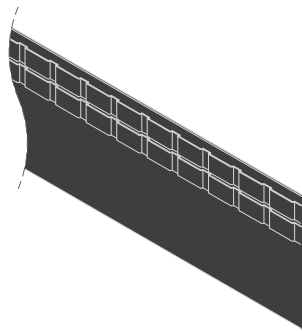
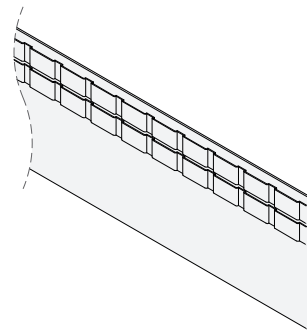

DOUBLE ROW

IRON ON TAPE

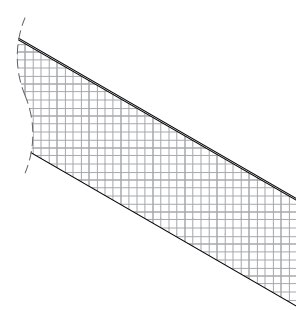

CURTAIN WEIGHT CORD

(Optional)

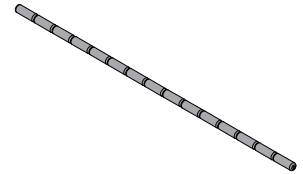

CURTAIN HOOKS

Colour Options: White • Black

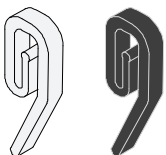

DRAW ROD CARRIER

(Optional)

Colour Options: White • Black

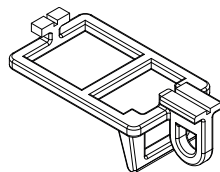

ADJUSTABLE BRAKE

(Optional)

Colour Options: White • Black

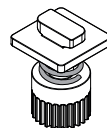



The curtain fullness indicated below and throughout this guide applies to finished curtain fabric. You will need to allow additional fabric for joins, hems and your usual workroom allowances.

WAVE GLIDERS

Wave Pitch: 80mm (3 1/8") (Standard) • 60mm (2 3/8")

Colour Options: White • Black



Glider Spacing	Curtain Hook Spacing	Pocket Spacing	Approx. Curtain Fullness	Stack Width per 1M (39 3/8") of pole	Stack Depth Front to Back	Min Bracket Projection
60mm (2 3/8")	120mm (4 3/4")	5	2.3	230mm (9 1/16")	120mm (4 3/4")	100mm (4")
80mm (3 1/8")	160mm (6 5/16")	7	2.3	180mm (7 1/16")	160mm (6 5/16")	100mm (4")

WAVE ROLLERS

Wave Pitch: 80mm (3 1/8")

Colour Options: White

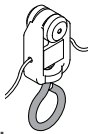

Roller Spacing	Curtain Hook Spacing	Pocket Spacing	Approx. Curtain Fullness	Stack Width per 1M (39 3/8") of pole	Stack Depth Front to Back	Min Bracket Projection
80mm (3 1/8")	160mm (6 5/16")	7	2.3	180mm (7 1/16")	160mm (6 5/16")	100mm (4")

80MM (3 1/8") POCKET SPACING

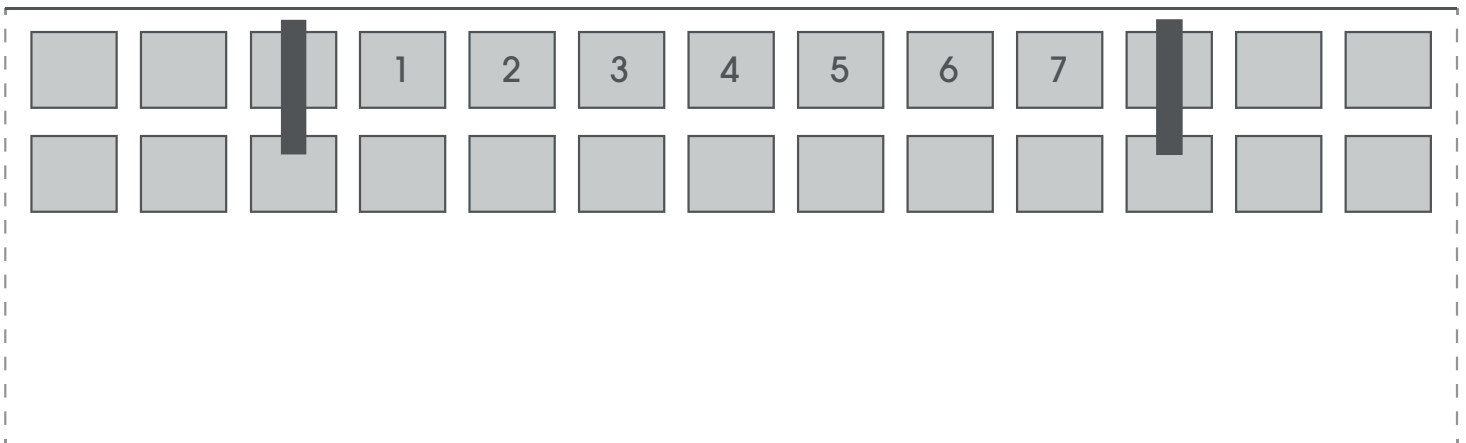

60MM (2 3/8") POCKET SPACING

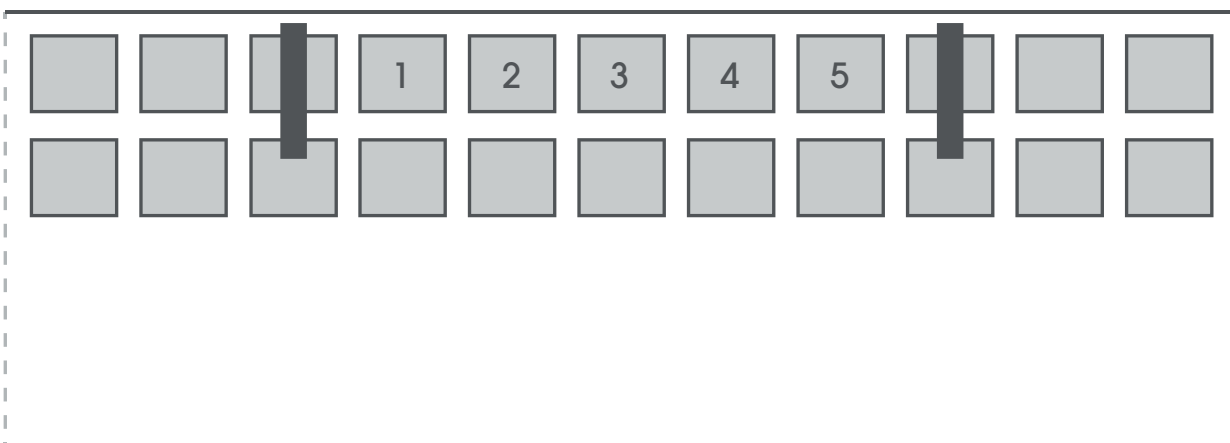

WAVE GLIDER • ROLLER - 80MM (3 1/8") SPACING STANDARD OPTION

Take the finished track size and find the corresponding size on the chart below to look up the number of hook points required.



Note an even number of hooking points are required.

Track length	Hook points per curtain.	
	Single Stack →	Pair Stack →←
400mm	6	--
560mm	8	6
720mm	10	6
880mm	12	8
1040mm	14	8
1200mm	16	10
1360mm	18	10
1520mm	20	12
1680mm	22	12
1840mm	24	14
2000mm	26	14
2160mm	28	16
2320mm	30	16
2480mm	32	18
2640mm	34	18
2800mm	36	20
2960mm	38	20
3120mm	40	22
3280mm	42	22
3440mm	44	24
3600mm	46	24
3760mm	48	26
3920mm	50	26
4080mm	52	28
4240mm	54	28
4400mm	56	30
4560mm	58	30
4720mm	60	32
4880mm	62	32
5040mm	64	34

Track length	Hook points per curtain.	
	Single Stack →	Pair Stack →←
5200mm	66	34
5360mm	68	36
5520mm	70	36
5680mm	72	38
5840mm	74	38
6000mm	76	40
6160mm	78	40
6320mm	80	42
6480mm	82	42
6640mm	84	44
6800mm	86	44
6960mm	88	46
7120mm	90	46
7280mm	92	48
7440mm	94	48
7600mm	96	50
7760mm	98	50
7920mm	100	52
8080mm	102	52
8240mm	104	54
8400mm	106	54
8560mm	108	56
8720mm	110	56
8880mm	112	58
9040mm	114	58
9200mm	116	60
9360mm	118	60
9520mm	120	62
9680mm	122	62
9840mm	124	64

Track length	Hook points per curtain.	
	Single Stack →	Pair Stack →←
10000mm	126	64
10160mm	128	66
10320mm	130	66
10490mm	132	68
10650mm	134	68
10810mm	136	70
10970mm	138	70
11130mm	140	72
11290mm	142	72
11450mm	144	74
11610mm	146	74
11770mm	148	76
11930mm	150	76
12090mm	152	78
12250mm	154	78
12410mm	156	80
12570mm	158	80
12730mm	160	82
12890mm	162	82
13050mm	164	84
13210mm	166	84
13370mm	168	86
13530mm	170	86
13690mm	172	88
13850mm	174	88
14010mm	176	90
14170mm	178	90
14330mm	180	92
14490mm	182	92
14650mm	184	94

WAVE GLIDER - 60MM (2³/₈") SPACING OPTIONAL

Take the finished track size and find the corresponding size on the chart below to look up the number of hook points required.



Note an even number of hooking points are required.

Track length	Hook points per curtain.	
	Single Stack →	Pair Stack →←
300mm	6	--
420mm	8	6
540mm	10	6
660mm	12	8
780mm	14	8
900mm	16	10
1020mm	18	10
1140mm	20	12
1260mm	22	12
1380mm	24	14
1500mm	26	14
1620mm	28	16
1740mm	30	16
1860mm	32	18
1980mm	34	18
2100mm	36	20
2220mm	38	20
2340mm	40	22
2460mm	42	22
2580mm	44	24
2700mm	46	24
2820mm	48	26
2940mm	50	26
3060mm	52	28
3180mm	54	28
3300mm	56	30
3420mm	58	30
3540mm	60	32
3660mm	62	32
3780mm	64	34

Track length	Hook points per curtain.	
	Single Stack →	Pair Stack →←
390mm	66	34
4020mm	68	36
4140mm	70	36
4260mm	72	38
4380mm	74	38
4500mm	76	40
4620mm	78	40
4740mm	80	42
4860mm	82	42
4980mm	84	44
5100mm	86	44
5220mm	88	46
5340mm	90	46
5460mm	92	48
5580mm	94	48
5700mm	96	50
5820mm	98	50
5940mm	100	52
6060mm	102	52
6180mm	104	54
6300mm	106	54
6420mm	108	56
6540mm	110	56
6660mm	112	58
6780mm	114	58
6900mm	116	60
7020mm	118	60
7140mm	120	62
7260mm	122	62
7380mm	124	64

Track length	Hook points per curtain.	
	Single Stack →	Pair Stack →←
7500mm	126	64
7620mm	128	66
7740mm	130	66
7860mm	132	68
7980mm	134	68
8100mm	136	70
8220mm	138	70
8340mm	140	72
8460mm	142	72
8580mm	144	74
8700mm	146	74
8820mm	148	76
8940mm	150	76
9060mm	152	78
9180mm	154	78
9300mm	156	80
9420mm	158	80
9540mm	160	82
9660mm	162	82
9780mm	164	84
9900mm	166	84
10020mm	168	86
10140mm	170	86
10260mm	172	88
10380mm	174	88
10500mm	176	90
10620mm	178	90
10740mm	180	92
10860mm	182	92
10980mm	184	94

CALCULATE THE LENGTH OF THE HEADER TAPE

Check your order paperwork, the number of Sine Gliders/Ripple Rollers the system should be listed.

If you can not find this information please call to sales desk, who will be happy to help.

Alternatively use the number of gliders calculated from the previous stage to determine the length of your heading tape.

There are two ways to calculate how much heading tape you require.

A

To calculate how much heading tape you require, visit www.bradleycollection.com/downloads/ and download the Gliderpole Wave Calculator. This tool automatically calculates the heading tape required.

- 1 Select Collection
- 2 Select single or pair stack
- 3 Input the pole length
- 4 See calculated Hooking Points and Pocket total

B

To calculate the length of the tape follow these steps

- 1 Take the number of gliders from the previous chart
- 2 Subtract 1
- 3 Multiply this number by the pocket spacing (7as standard)
- 4 Add back on the total amount of glider from step 1
- 5 For 60mm (2³/₈") Add on a further 8 pockets
For 80mm (3¹/₈") Add on a further 10 pockets
- 6 Calculate pocket total

EXAMPLE

1500mm Wide with a pair stack. Using 80mm (3¹/₈") glider cord with 160mm (6¹/₈") hook spacing:

- 1 12
- 2 $12 - 1 = 11$
- 3 $11 \times 7 = 77$
- 4 $77 + 12 = 89$
- 5 $89 + 10 = 99$ pockets
- 6 **Therefore your tape length will be equal to 99 pockets.**



Pockets should be counted Not measured
Do not cut your fabric yet!

- 1 Cut the pocket tape according to the number of pockets.
The pocketed tape has a small stitch mark every 50 pockets to help count out the correct length of tape.

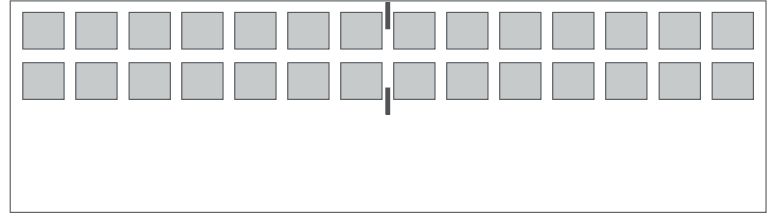

- 2 Turn in 2 pockets at each end of the tape.
Now you have your finished curtain width, measure this to cut your fabric.

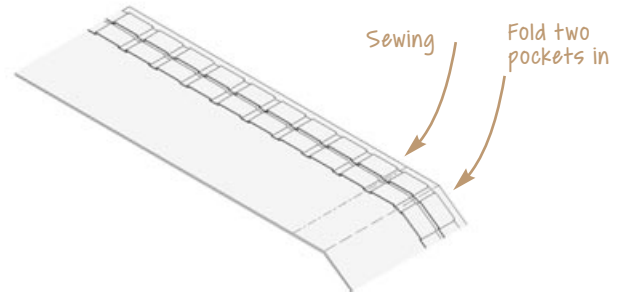

- 3 We recommend that you use an iron tape to avoid fabric puckering and give a professional finish to the top hem.

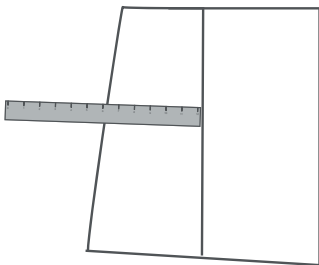

- 1 Measure the hem to
75mm (3") if using gliders
95mm (3 3/4") if using rollers

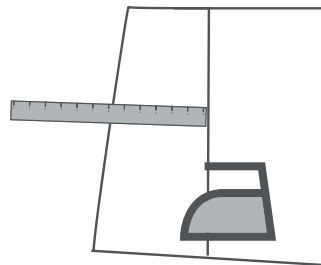

- 2 Iron the into position.

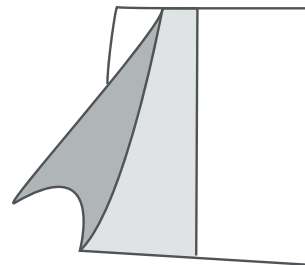

- 3 Lift the hem back and lay on
the iron-on tape

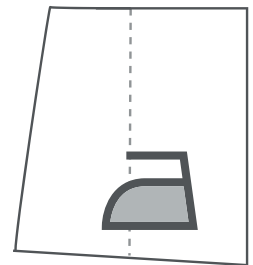

- 4 Iron the hem so that the tape melts
Ensure the two parts are stuck together

- 4 The tape can now be sewn to the top of the curtain.
This has been calculated to give the correct hook drop when sewn in position.

! Note If using roller cord sew the tape 7mm (3/4") from the top of the curtain. This ensure the correct hook drop

**HEADER
TAPE
POSITION
GLIDERS**

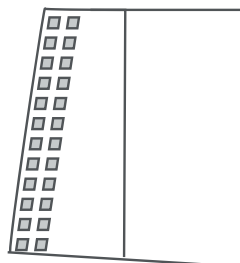

**HEADER
TAPE
POSITION
ROLLERS**

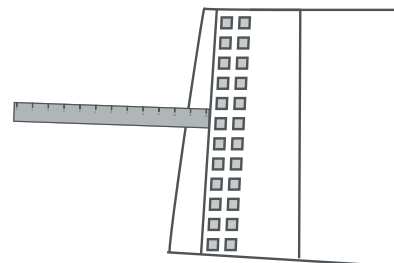

5 Insert the hooks based on the diagrams below.

STANDARD SPACING BETWEEN CURTAIN EDGES

80mm (3 1/8") Gliders & Rollers

Insert the first hook into the fourth pocket

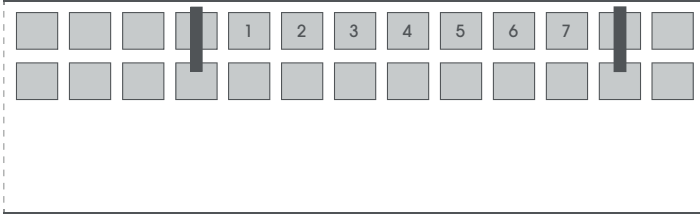

60mm (2 3/8") Gliders

Insert the first hook into the third pocket

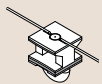
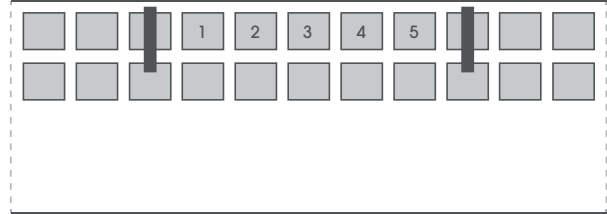

IF YOU ARE USING WAVE GLIDER CORD, HOOKS ARE POSITIONED IN THE TOP ROW OF POCKETS.

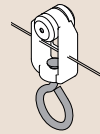

IF YOU ARE USING WAVE ROLLER CORD, HOOKS ARE POSITIONED IN THE BOTTOM ROW OF POCKETS.

6 When hanging the curtain pull the first fold towards you and the second away from you.

CURTAIN DRESSED CORRECTLY

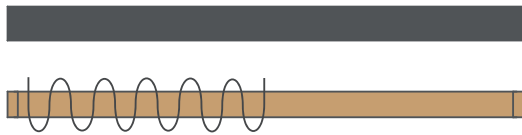

CURTAIN DRESSED INCORRECTLY

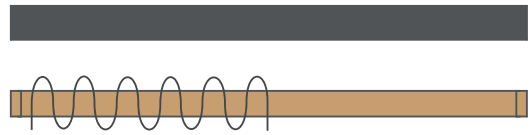

7 If the fabric does not automatically fall into the wave at the bottom we recommend you try using a lead weight cord in the hem and fabric side weights.

CONTACT

www.bradleycollection.com



UK & REST OF THE WORLD

+44 (0)1449 722 724

info@bradleycollection.com

USA & CANADA

+1 (310) 815 8255

info.us@bradleycollection.com

LONDON SHOWROOM

+44 (0)207 871 7793

showroom@studiotwochelsea.com

THE BRADLEY COLLECTION



Industry Partner

Supporting the interior design profession

CEDIA
MEMBER

Specialised fixings for mounting brackets will be required in certain situations and are not provided as standard. Steel items are not recommended for damp conditions such as shower rooms. Crystal finials should not be positioned in direct sunlight, and are not suitable for use in conservatories. Fluid Metal items are supplied unlacquered and will tarnish over time.

The Bradley Collection reserves the right to modify design and materials without prior notice as part of a process of continual product improvement. Due to printing limitations, colours in this brochure may not be accurate.

Products are protected by Design Rights, under provisions of Copyright, Designs & Patents Act 1988. Bradley®, The Bradley Collection® and  Logo are registered Community trademarks of The Bradley Collection Ltd. in Europe and registered trademarks of the Bradley Collection, Inc. in the USA.

The Bradley Collection Ltd Lion Barn • Maitland Road • Needham Market • Suffolk • IP6 8NS • UK